

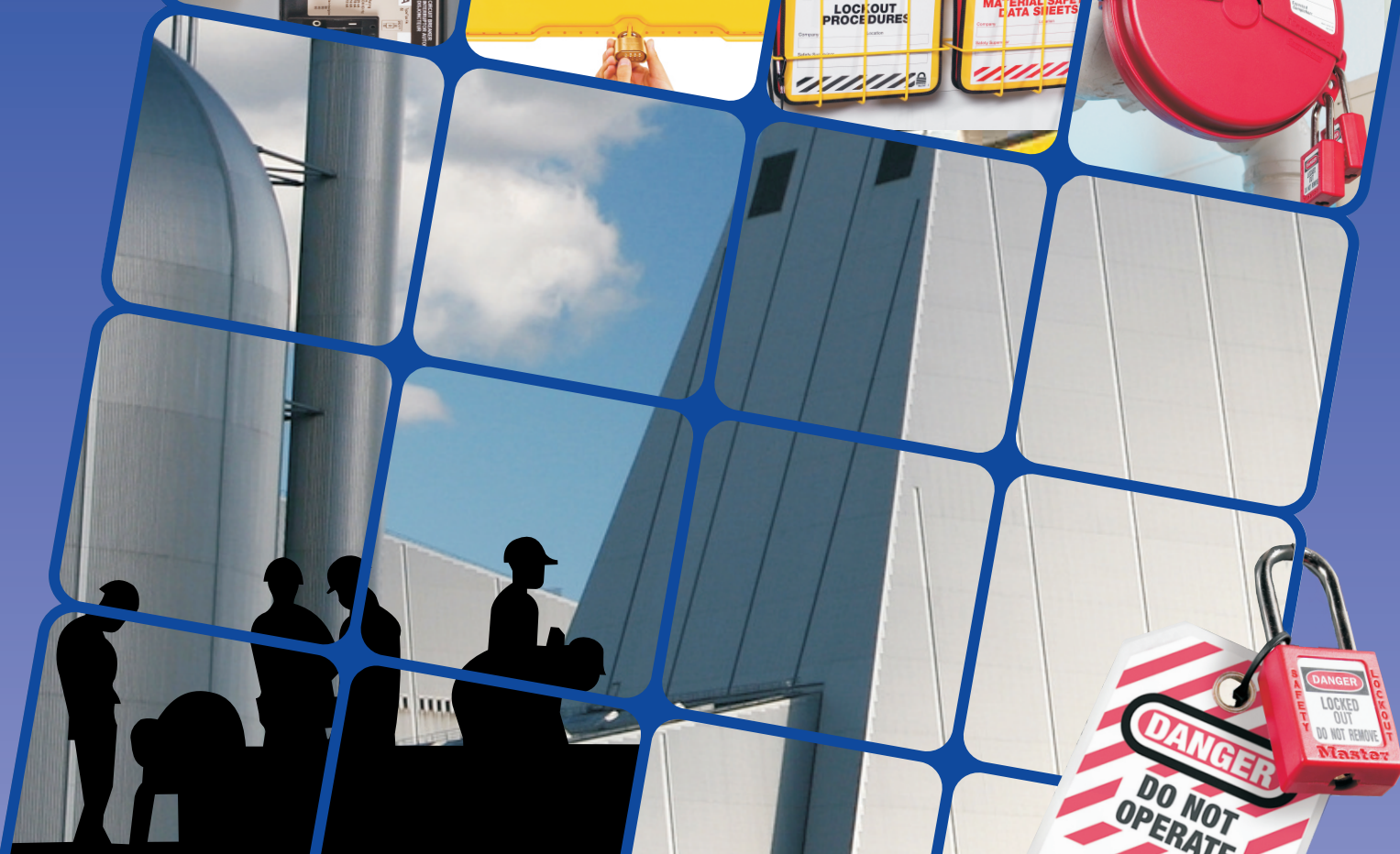

ACT. PROTECT. COMPLY.

INDUSTRIAL PLANT SAFETY



Safety Lockout Tagout Products Safety Signs

Protect Employees & Comply With Legislation

Online Ordering: www.LockoutTagout.co.uk



ACT. PROTECT. COMPLY.

Lockout Tagout Safety Ltd

We stem from a local family business established in 1883, and specialising in general security and safety, within Industrial Teesside, UK. However, our work in this side of the industry has helped us to realise the **niche service** which provides modern solutions for industrial plant safety, i.e. lockout/tagout, which instructs workers and their employers to keep to safe systems of work **world wide**.



William Appleyard, 1883

Phrases such as "Accidents will happen" give no comfort to the families or employers of those who lost their lives or were injured during the course of their employment, and we prefer to adhere to the belief that "Accidents can be prevented." **Lockout Tagout Safety Ltd provides** the devices to stop such accidents.

Statistics produced by the UK Health and Safety Executive show that in the year 2008/9 180 workers were killed at their place of work, 131,895 other injuries were reported and 246,000 reportable injuries were recorded.

Our operational mission is simple – namely to provide a comprehensive range of safety and security products which give peace of mind to you, your staff and your visitors, and which prevent you from adding to the tragic accident statistics.

All businesses are obliged to operate under a wide range of codes of practice and regulations in respect of safety. Failure to do so can result in legal action and severe penalties for the employer. Lockout Tagout Safety Ltd exists to provide you with a guide to those regulations covering your business and the nature of its operations, and to make available to you legally approved safety products which you can utilise with confidence. For example, according to the OSHA standard 1910.147 - Lockout Tagout, it is important that there is no unwarranted duplication of keys. As the number of locks increase so does the complexity of tracking keys. Lockout Tagout Safety Ltd are the expert at managing your key changes and ensuring fit for purpose safety padlocks.

We are premier providers of world leading lockout tagout equipment. Lockout Tagout Safety Ltd is a popular provider of quality Lo-To products to both UK and World markets.

Online Ordering and Prices



There are various ways to obtain up to date prices, (ex VAT) :-

- 1) **Order help line number** +44 (0) 1642 244017
- 2) **Email and request quote** with large order volume discounts available.
- 3) **Instant Fastpath** the price by going onto our website www.LockoutTagout.co.uk and follow this simple step:

Find web prices in just one step:-

After you have found the product you are interested in within this catalogue, type the product number into this search field on our website and that's it. Price found!

To Buy

Once you have found the product you require Simply click add to cart and follow payment process.

Lockout Tagout

Legislation.....	2
Product Groups.....	5

Mechanical Risk

Universal Risks.....	6
Ball Valve Lockout Devices.....	7
Gate Valve Lockout Devices.....	9
Cable Lockout Devices.....	11
Butterfly Valve Lockout Devices.....	12
Cylinder Lockout Devices.....	13
Pneumatic Lockout Devices.....	13
Steering Wheel Covers.....	14

Electrical Risk

Plug Lockouts.....	15
Circuit Breaker Lockouts.....	17
Wall Switch Lockouts.....	21

Lockout Kits

Ultimate Lockout Kit.....	22
Series Compliance Centres.....	23
Personal Lockout Pouches.....	23
Personal Lockout Kits.....	24
Group/Team Lockout Kits.....	25
Master Lock® Lockout Kit Range.....	25
Brady® Lockout Kit Range.....	26

Locks, Hasps & Accessories

Keying & Charting Options.....	27
Padlocks & Accessories.....	28
Lockout Hasps.....	40

Lockout Storage

Lockout Stations.....	43
Tag Stations.....	45
Lock Boards.....	46
Padlock Stations.....	47
Lock Boxes.....	47
Padlock Centre.....	48
Lockout Pouches.....	49

Key Control Systems

Economy Range.....	50
Key Group Lockout Boxes.....	50
Alternative Lock Options.....	50
High Security Key Filing System.....	51
Key Vault.....	52
System Cabinets.....	53
Security Systems.....	54
Self Retracting Key Reels.....	55

Cable Seals

Cable Lock Seals.....	56
Cable Breakaways.....	56
Bolt Seals and Indicative Seals.....	57

Tagout

Tags & Labels.....	58
DO NOT OPERATE ID Tags.....	60
Tag Holders.....	60
Tag Stations.....	60
Safety Management System.....	61
Coloured Nylon Ties.....	62
Lockout Signs.....	62
Magnetic Identification.....	62
Scafftags.....	63
Custom Tags.....	63

 You will find the lock icon, as displayed on the left, throughout this catalogue. It indicates information that will help you choose the right lock to use with our lockout devices.

Need Safety Signs/Factory Notices & Custom Tags?

You can download any of our Safety Sign catalogues FREE from our home page. Simply visit www.LockoutTagout.co.uk and click on the Download Catalogue icon



Legislation



Corporate Manslaughter and Corporate Homicide Act 2007

Thousands of workers get killed or injured every year while repairing or maintaining industrial equipment and machinery. These accidents often occur as a result of the uncontrolled release of energy. In order to stop this from happening, several policies exist within Europe requiring that all energy sources are turned off and 'locked out' while machines are being serviced or repaired.

What is it?

Lockout Tagout is a planned safety procedure that disables the energy supply of industrial machinery and equipment whilst servicing, maintenance work or repairs are in progress. The aim of this system is to effectively protect workers from the dangers created by live machinery or electricity, therefore lowering the overall level of risk when working with this equipment.



Why Lockout/Tagout?

- Provides safety when completing maintenance, cleaning or carrying out repairs
- Prevention of injuries
- Prevention of damage
- Generally helps the evasion of errors
- It is a useful safety procedure which clearly communicates the risks in the workplace and how easily these dangers may be avoided.

When you neglect Lockout Tagout you neglect people.

Current Legal Requirements

In the UK the Provision of Work Equipment Regulations – Regulation 19 – Isolation from Sources of energy states: "Every employer shall ensure, that where appropriate, work equipment is provided with suitable means to isolate it from all its sources of energy. Every employer shall take appropriate measures to ensure that re-connection of any energy source to work equipment does not expose any person using the equipment to any risk to his health or safety".

The EU Guidelines 89/655 specify the minimum requirements concerning safety and health while using equipment. Paragraph 2.14 lays down that "every piece of equipment must be fitted with clearly visible devices with which it can be separated from every energy source".



OSHA Regulations (USA)

OSHA regulation The Control of Hazardous Energy (Lockout / Tagout) 1910.147 states that it "requires employers to establish a program and utilise procedures for affixing appropriate lockout devices or tagout devices to energy isolating devices and to otherwise disable machines or equipment to prevent unexpected energisation, start up or release of stored energy in order to prevent injury to employees".

Lockout/Tagout training DVD

Comply with regulations and provide safety training to every member of staff. To ensure that all the relevant members of staff receive safety training decreases both the risk of accidents occurring in the workplace and their associated costs.



Lockout For Life

Learn from other workers' tragic mistakes. This motivational video presents six real-life dramatizations of actual lockout accidents and analyses how they could have been prevented

- Suitable for new and experienced employees

Duration: 19 minutes

Order Ref.
805855-BR

Safety Series™ Installation

- 18 installation videos for Safety Series™ lockout products
- The videos allow you to clearly see how the device works in situation
- Also suitable for employee-refresher training sessions
- Only music playing. No text, no speech.
- The DVD menu will allow you to play all 18 (about 14 minutes) or select a specific product video to play
- Can be played in a standalone DVD player or in a computer with DVD playing software
- These videos are viewable on the Safety Series™ websites : www.safetyseries.co.uk

Lockout/Tagout Procedure Employee Reference Card

- Technical sheet for Lockout/Tagout training
 - What is Lockout/Tagout?
 - Who is involved in Lockout/Tagout?
 - Applying Lockout/Tagout – The 7 steps
 - Release from Lockout/Tagout – The 5 steps



499PR-ML

Order Ref.	Description
J1615-ML	Safety Series Installation Videos
499PR-ML	Lockout/Tagout Procedure Employee Reference Card (pack of 10 cards)



Workshops and Training

Call for details on 01642 244017

Lockout Tagout Safety Ltd aims to provide a wide range of resources so that customers can make informed decisions when purchasing safety equipment.

It also ensures that employers and workers can keep up to date with the latest legislation on safety in the workplace.



Legislation

Establishing a good Lockout/Tagout programme requires 3 basic steps:

1



Develop a Written Program

Identify and write out all procedures for the control of hazardous energy, planning for scenarios such as the preparation for shutdown, equipment isolation, Lockout/Tagout application, release of stored energy and finally the verification of energy isolation to each piece of equipment.

2



Training Employees

It is crucial that both affected and authorised employees are trained in the specific energy control procedures established by the company. Verification of this training is required.

3



Implement the Program

As well as developing and identifying format written procedures and training employees, Lockout Tagout Safety Ltd offers a selection of products including padlocks, tags, signs and lockout devices to help you implement lockout procedures for many different energy sources, including: electricity, pneumatics, steam, gas, liquids and many others.

General Lockout Procedure

The following steps should be included in your Lockout Tagout procedure in order to aid personnel in safe completion of work activity.

Issue a work order (or similar procedure), which determines the task and the equipment that is to be locked down.

Notify the affected employees that Lockout is about to occur, including the operator of the equipment.

Limit the work area, if permissible, by erecting a safety perimeter.

Prepare for shutdown by reviewing details of the energy source, hazards, and your company's control procedures.

Shut down the equipment/machinery using the normal, safety procedure.

Isolate all applicable energy sources.

Apply padlocks to the energy isolating devices.

Apply tags in order to provide information regarding the lockout of isolation devices & switches.

Dissipate, then confine and block the residual energy that may be present.

Apply padlocks to the residual energy blocking devices.

Apply tags in order to provide information regarding the lockout of the residual energy devices.

Verify the absence of energy by using the most reliable and safest means possible, e.g. start-up test.

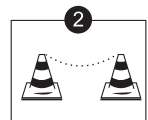

ACT. PROTECT. COMPLY.

Lockout: Devices for risk prevention

Mechanical Risk

Universal Risks	6
Lockout for valves in all positions	6
Ball Valve Lockout Devices	7
Lockouts for valves in closed position	7
Lockout for valves in open & closed position	7
Handle-on Ball Valve Lockout	8
Seal Tight™ Ball Valve Lockout	8
Gate Valve Lockout devices	9
Adjustable Gate Valve Lockout	9
Standard Gate Valve Lockout	9
Rotating Gate Valve Lockout	10
Pressurized Gate Valve Lockout	10
Cable Lockouts	11
Adjustable Cable Lockout	11
Pro Lock II®	11
Universal Valve Lockout	11
Butterfly Valve Lockout	12
Universal Valve Lockout	12
Cylinder Lockouts	13
Cylinder Tank Lockout	13
Gas Cylinder Lockout	13
Pneumatic Lockouts	13
Pneumatic Quick-Disconnect Lockout	13
Pneumatic Lockout - All Purpose	14
Steering Wheel Covers	14

Electrical Risk

Plug Lockouts	15
Large Electrical/Pneumatic Lockout	15
Lockout device for Plug Connections	15
Hubbell Plugout	15
Electrical Plug Lockout	16
Push Button and Rotary Switch Cover	16
Oversized Plug & Hoist Control Cover	16
Circuit Breaker Lockouts	17
Universal Multi-Pole Breaker Lockout	17
Economy Multi-Pole Breaker Lockout	17
Single Pole Breaker Lockout	17
"No Hole" Circuit Breaker Lockout	17
Circuit Breaker Lockout Kit	18
Miniature Circuit Breaker Lockout	18
Oversized Breaker Lockout	19
480-600V Breaker Blocker	19
Brady® Miniature Circuit Breaker Lockouts	20
Grip Tight Circuit Breaker Lockout	21
Circuit Breaker Switch Padlock	21
Wall Switch Lockouts	21

Lockout Kits

Ultimate Lockout Kit	22
Personal Lockout Pouches	23
Series Compliance Centres	23
Personal Lockout Kits	24
Master Lock® Group Lockout Kits	25
Electrical and Valve Lockout Kit	25
Valve Lockout Kit	25
Electrical Lockout Kit	25
Brady® Lockout Kits	26
Small Adjustable Lockout Kit	26
Gate Valve Lockout Kit	26
Custom Lockout Kits	26

Locks, Hasps & Accessories

Keying & Charting Options	27
Padlocks and Accessories	28
Zenex™ Safety Padlocks	28
Brady® Safety Padlocks	30
ABUS® Safety Padlocks	30
Abloy® Safety Padlocks	32
Brass Padlocks	36
Combination Padlocks	37
Accessories	38
Lockout Hasps	40
Safety Lockout Hasps	40
Non-Conductive Lockouts	41

Lockout Storage

Lockout Stations	43
Tag Stations	45
Lock Boards	46
Padlock Station	47
Lock Boxes	47
Padlock Centre	48
Lockout Pouches	49

Key Control Systems

Economy Range	50
Key Group Lockout Boxes	50
Alternative Lock Options	50
High Security Key Filing Systems	51
Key Vault	52
System Cabinets	53
Security Systems	54
Self Retracting Key Reels	55

Cable Seals

Mini Cable Lock Seals	56
Midi Cable Lock Seals	56
Maxi Cable Lock Seals	56
Cable Breakaways	56
Bolt Seals and Indicative Seals	57

Tagout: Communication of risks

Tags and Labels	58
Warning Tags	58
Warning Tags: Machine Related Risks	59
Self Adhesive Labels: Machine Safety	59
Brady Safety Tags	59
DO NOT OPERATE ID Tags	60
Tag Holders	60
Tag Stations	60
Safety Tag Station	60
Compact Tag Stations	60
Safety Management System	61
Safety & Maintenance Record Tags	61
Self Adhesive Labels	61
Coloured Nylon Ties	62
Lockout Signs	62
Magnetic Identification	62
Magnetic Signs	62
Pouches with Magnetics Strips and Loops	62
Scafftags	63
Custom Tags	63

Mechanical Risk: Universal Risks

Universal Valve Lockout: One device does it all!

The Universal Lockout device is a modular system which enables you to lock out valves of different types and sizes. No other device offers such flexibility and security. There are two sizes available: large and small.

- Modular system makes your investment economical and flexible
- Can be used to lock out large levers, T-handles and other hard-to-secure mechanical devices
- New open-ended clamp fits over closed rings, wide handles
- Locks out valves in open and closed positions
- Made from industrial-grade steel and nylon for rugged durability, chemical and corrosion resistance
- Max. shackle diameter: 9 mm
- Min. shackle clearance: 20 mm

Order Ref.	Description
050924-BR	Small Universal Valve Lockout Base Clamping Unit
050899-BR	Large Universal Valve Lockout Base Clamping Unit
065402-BR	Small Blocking Arm
065403-BR	Large Blocking Arm
051395-BR	Cable attachment with 2.44 metre sheathed cable Cable diameter 3.25 mm

Maximum valve handle width	
Small Lockout: 25 mm	Large Lockout: 41 mm
Maximum handle thickness	
Small Lockout: 19 mm	Large Lockout: 31.75 mm

The Universal Lockout is a modular construction where the user can add various accessories to make the device suitable for a range of valves. Simply disassemble the device (as shown in picture) and slot in the relevant accessory.

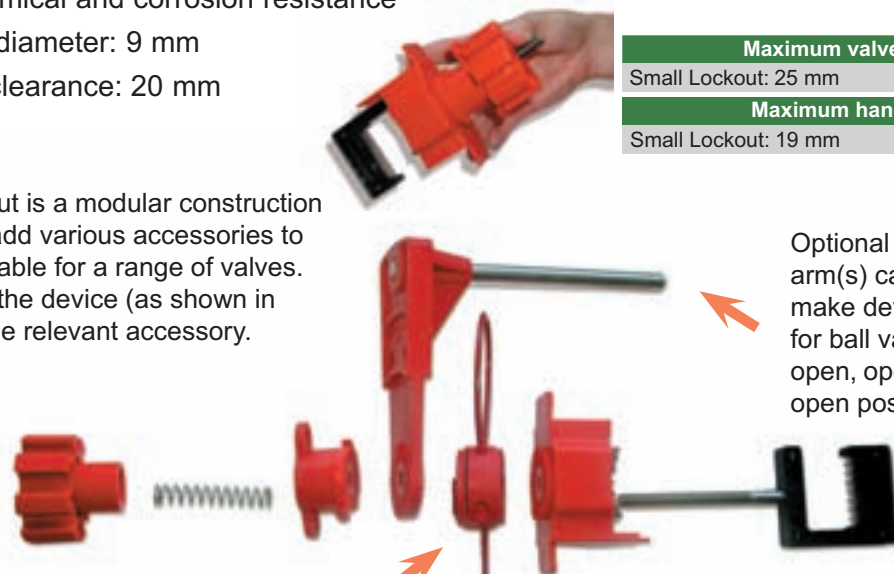

Optional blocking arm(s) can be added to make device suitable for ball valves in half-open, open or partially open positions

Cable attachment can be added to make device suitable for locking off gate valves



Clamp attaches to butterfly valve lever, preventing trigger handle from being squeezed. Valve cannot be repositioned!



Use blocking arm to lock out quarter-turn ball valves



Use cable attachment to lock out gate valves



Use two blocking arms to lock out 3-, 4- or 5-way valves, or to lock valves in the throttled position for operational control

Lockouts for valves in **closed** position

Brady® Ball Valve

- Locks quarter-turn ball valves in OFF position
- Fits virtually any valve lever up to 76 mm
- Very compact and lightweight solution
- Available in 2 sizes
- Packaging: 1 piece

Order Ref.	Size valve lever	Minimum shackle clearance	Material
065666-BR	6 - 25 mm	25 mm	Nylon
065692-BR	6 - 25 mm	19 mm	Steel
065669-BR	32 - 76 mm	19 mm	Steel
065693-BR	32 - 76 mm	19 mm	Steel



Order Ref.	A mm	B mm	C mm	D mm	E mm	F mm	G pieces	G Ø
065666-BR	80	30	60	8	12	71	8	7.5
065692-BR	87	30	50	8	11	63	6	10
065669-BR	150	30	110	10	15	110	15	7.5
065693-BR	150	30	110	10	15	110	7	10

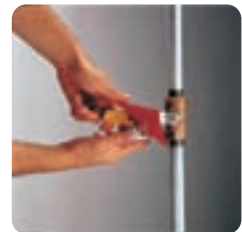

Non-Conductive Ball Valve Lockout



- Non-conductive
- Intuitive and easy to place
- Locks quarter-turn ball valves in OFF position
- Made from strong polypropylene plastic, resistant to cracking, abrasion and chemical products
- Resistant to extreme temperature changes -46 to 183°C
- Max. shackle diameter: 7 mm
- Min. shackle clearance: 20 mm
- Packaging: 1 piece

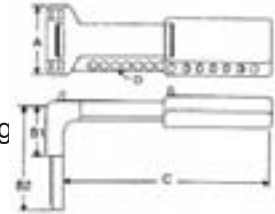

Order Ref.	Width (A)	Height (B)	Length of lever (C)	Lock hole (D)
225340-BR	95 mm	125 mm	190 to 250 mm	8 mm

Lockout for valves in **open & closed** position

Prinzing Ball Valve Lockout

- Small device locks out pipes from **12.5 to 31 mm** in **open and closed** position
- Large device locks out pipes from **50 to 200 mm** in **closed** position
- Versatile and easy to use
- The two halves of the device encompass the ball valve lever to secure it from inadvertent activation of the valve
- Made from ultra-tough polypropylene
- Max. shackle diameter: 6.5 mm
- Min. shackle clearance: 38 mm
- Packaging: 1 piece



Order Ref. Red	Order Ref. Blue	Order Ref. Green	Order Ref. Yellow	Type
800110-BR	805847-BR	805848-BR	805849-BR	Small
800111-BR	805850-BR	805851-BR	805852-BR	Large



See page 9 for tips on how to use different colours

Mechanical Risk: Ball Valves

Handle-on Ball Valve Lockout



Steel pin fits behind stopper bar

Jaws clamp tight on valve stop

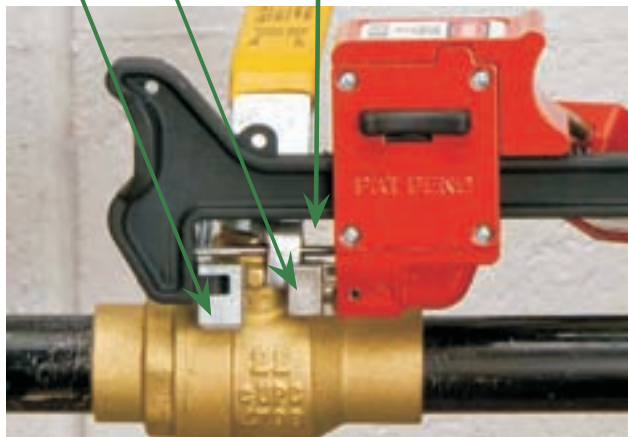



Technical Features

- Aluminium & Steel composite body
- Heat resistance
- High chemical resistance
- Corrosion resistance
- Fits 6.35mm to 100mm ball valves



Handle Ball Valve Lockout fits into virtually all manual, quarter-turn ball valve handles to protect against accidental valve opening.

- Clamps tight on handle stop to prevent handle movement
- Works on a wide range of ball valve sizes
- Works on insulated pipes and in close quarters
- Ergonomic to optimize tightening on valve handles
- Durable aluminium & steel construction defies corrosive environments and temperatures up to 532 degrees
- Lightweight and compact for easy carrying and storage
- S3068MLP is available with labels in Czech, English, French, Spanish, Flemish/Dutch, German, Italian, Japanese, Mandarin, Chinese, Polish, Portuguese & Russian.

Ball Valve Lockout Option	ODD Orientation	Pipe Material Installation	Tight Clearance
<p>Order Ref. S3068MLP</p>			

Seal Tight™ Ball Valve Lockout

The solution that positively shuts off energy

Provides Universal Fit for Valve Applications and Diameters

- Another exclusive Master Lock® Safety Series™ lockout device, the Seal Tight™ device works on virtually all valve sizes and in all applications
- Patent-pending innovative design eliminates the risk of valve operation. With Seal Tight™, remove and store the handle and conceal the valve stem for secure lockout
- Works in virtually all valve installations – metal and PVC valves, insulated pipes, pipes mounted close to a wall or ceiling, and valves with tight access due to close proximity of other valves or pipes
- Temperature resistance (-40° C to 121° C).



Fits Tight Clearances
Easy to use Universal Fit

Order Ref.
468L-ML





Adjustable Gate Valve Lockout

- Adjusts to fit gate valves from **2.5 to 16.5 cm**
- **One device for most gate valves**
- Replaces 3 conventional gate valve lockouts = reduced costs
- Durable polypropylene
- Resistant to extreme temperature changes from -45 to 182°C
- Max. shackle diameter: 7 mm
- Min. shackle clearance: 20 mm
- Packaging: 1 piece



Order Ref.
064057-BR



Standard Gate Valve Lockout

- Locks out gate valves from 2.5 to 32 cm
- Made of durable polypropylene – superior impact & chemical resistance
- Withstands temperatures from -30 to 150°C
- Available in 5 sizes and 4 colours
- Comes with danger labels in English, Spanish and French
- Max. shackle diameter: 6.5 mm
- Min. shackle clearance: 38 mm
- Recommended lock:
 - Safety Packlock (page 32)
 - Safety Lockout (page 43)
- Packaging: 1 piece



Hand wheel diameter (mm)	Order Ref. Red	Order Ref. Yellow	Order Ref. Green	Order Ref. Blue
25 - 64	065560-BR	065590-BR	065595-BR	065585-BR
64 - 127	065561-BR	065591-BR	065596-BR	065586-BR
127 - 165	065562-BR	065592-BR	065597-BR	065587-BR
165 - 254	065563-BR	065593-BR	065598-BR	065588-BR
254 - 320	065564-BR	065594-BR	065599-BR	065589-BR
320 and larger (see cable lockout devices)				

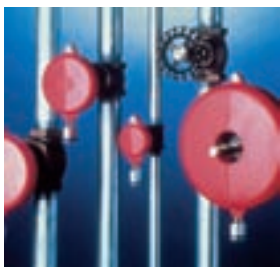

Hand wheel diameter (mm)	Dimensions (mm)						
	A	B	C	D	E	F	G
25 - 64	75	20	-	19	69	33	39
64 - 127	140	20	30	42	130	36	46
127 - 165	170	20	51	63	167	43	53
165 - 254	270	20	70	90	260	63	70
254 - 320	350	25	75	100	340	70	80

Unique knockout feature: can be removed by hand to accommodate "rising stem" gate valves

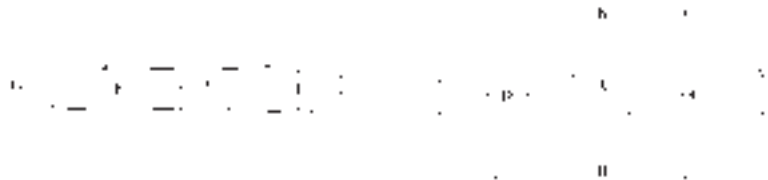

WHY USE DIFFERENT COLOURS?

- **Valves in open or closed position:** red = open, green = closed
- **Indicate risk levels:** red = high risk, blue = low risk
- **Indicate substances flowing through a valve:** yellow = gas, green = water
- **Indicate different maintenance teams:** red = electricians, blue = mechanics

Mechanical Risk: Gate Valves

The exclusive, patent pending Master Lock® gate and ball valve lockout devices work in difficult applications like tight spaces and insulated pipes.

Rotating Gate Valve Lockout

Outward/Inward Rotation Allows for Easier Installation & Secure Lockout

- Tough, lightweight, dielectric Zenex™ thermoplastic bodies withstand chemicals; perform effectively in extreme conditions temperature range (-47° C to 177° C)
- Surrounds the valve operating handle to protect against accidental valve operation
- Unique, rotating design allows for easier installation in confined space applications
- Center knockout can be removed for rising stem gate valves
- Each size rotates into itself and nests within the next larger size to save space in storage
- Multiple workers can apply their personal safety locks
- Complete with high-visibility permanent safety labels (English, French & Spanish) that can be written-on to identify the responsible person, then erased for the next job.



482-ML



484-ML



483-ML

Order Ref.	Description
480-ML	Gate valve lock-out - 25 to 76mm
481-ML	Gate valve lock-out - 50 to 127mm
482-ML	Gate valve lock-out - 101 to 165mm
483-ML	Gate valve lock-out - 152 to 254mm
484-ML	Gate valve lock-out - 203 to 330mm
485-ML	Set of five sizes of gate valve lock-out - 480-ML to 484-ML



485-ML



Large Order? Call for Quote!

Pressurized Gate Valve Lockouts

Fits Pressurized Gas Valves

- Surrounds the valve handle to protect against accidental valve operation
- Design works with valve guard in place
- Fits virtually all pressurized gas valves up to 7.6 cm diameter
- Compact size easily stored when not being used
- Includes Danger labels in English, Spanish, and French
- Accepts any Master Lock® or American Lock® Safety Padlock.



Order Ref.	Description
S3910-ML	Pressurized Gas Cylinder Lockout

Zenex™ is a registered trademark of Master Lock®

Mechanical Risk: Cable Lockouts



Adjustable Cable Lockout

Infinitely Adjustable for a secure fit every time

- Integrated safety hasp and cable is ideal for multiple circuit breaker panel and side-by-side gate valve lockouts
- Tough, flexible multi-stranded 6.35 mm dia. Steel cable is insulated with a clear vinyl coating
- Feed the cable end through the points to be locked out, then back through the lockout body Cinch it tight to remove any slack with the patented locking feature
- Tough, lightweight Zenex™ thermoplastic body withstands chemicals; performs effectively in extrem conditions (-47°C to +149°C).

Order Ref.	Description
S806-ML	Adjustable cable lockout 1830mm - ø 4 mm cable
8611-ML	Adjustable cable lockout with 1.80 m - ø 6mm cable
8615-ML	Separate 4.50 m - ø 6mm cable for use with 8611-ML



Power Plant No1 Choice

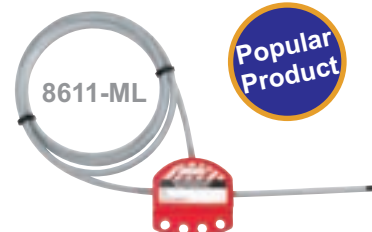
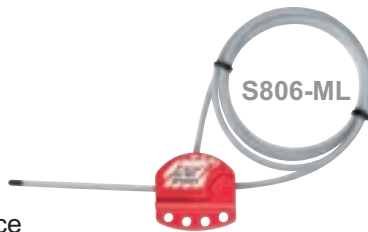

PRO-LOCK II® Cable Lockout Device

- Can only be opened and locked by using special tool (not included)
- Compact and lightweight
- Moulded from an impact polymer polypropylene with stainless steel internal parts.
- UV stabilised
- Temperature resistance range: -50°C to 55°C
- Diameter PRO-LOCK: 50 mm
- Cable length: 1.50 m
- Max. shackle diameter: 6.5 mm
- Min. shackle clearance: 20 mm
- Packaging: 1 piece



Special Operating Tool

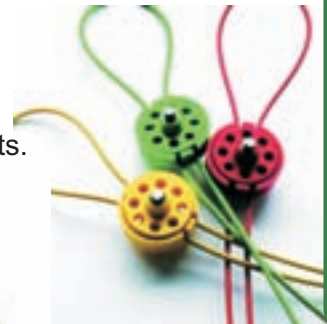

Order Ref.	Description	Material	Colour
225203-BR	Pro-Lock + cable 1.5 m	Polypropylene moulding & stainless steel	Red
225204-BR	Pro-Lock + cable 1.5 m	Polypropylene moulding & stainless steel	Green
225205-BR	Pro-Lock + cable 1.5 m	Polypropylene moulding & stainless steel	Yellow
225206-BR	Operating tool	Polypropylene	Red
225207-BR	Operating tool	Polypropylene	Green
225208-BR	Operating tool	Polypropylene	Yellow



Other cable lengths are available upon request



Universal Valve Lockout

Lockout gate valves using the cable attachment with the Universal Valve Lockout. See page 6 for more information. For this lockout you would need to order:

Order Ref.	Description
050924-BR	Small Universal Valve Lockout Base Clamping Unit
050899-BR	Large Universal Valve Lockout Base Clamping Unit
051395-BR	Cable attachment with 2.44 metre sheathed cable

Zenex™ is a registered trademark of Master Lock®

Mechanical Risk: Butterfly Valves

Butterfly Valve Lockout

Created to secure your butterfly valve efficiently!

- Made of strong polypropylene plastic
- Fully dielectric (non-conductive)
- Highly resistant to solvent and other chemical products
- Highly resistant to cracking and abrasion
- Resistant to extreme temperature changes from -46 to 183°C
- **2 Padlocks can be applied**
- Max.shackle diameter: 8 mm
- Min.shackle clearance: 25 mm
- Packaging: 1 piece



Available in 4 colours:
Red, Yellow, Green & Blue



Order Ref.	Colour
256960-BR	Red
256961-BR	Yellow
256962-BR	Green
256963-BR	Blue



See page 9 for tips on how to use different colours

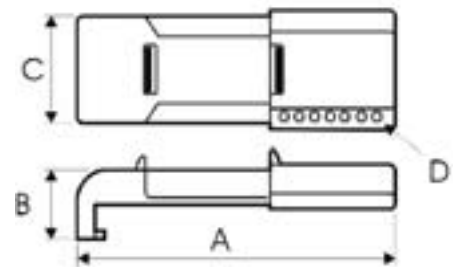

A	B	C	D
305 mm	70 mm	102 mm	9.5 mm

Universal Valve Lockout

Use the Universal Valve Lockout for locking out butterfly valves: the clamp attaches to the butterfly valve lever, preventing the trigger handle from being squeezed. The valve cannot be repositioned. See page 6 for more information. For this lockout format you would need to order:



Order Ref.	Description
050924-BR	Small Universal Valve Lockout Base Clamping Unit
050899-BR	Large Universal Valve Lockout Base Clamping Unit

Resource and Download Centre

Lockout Tagout Safety Ltd's Resource Centre provides a wide range of information and advice so that customers can make informed decisions when purchasing safety equipment. The Resource Centre Icon can be found on the right hand side of the website homepage and includes:

- Advice on what should be in your Lockout Tagout procedures
- Free A3 PDF poster detailing the general steps of Lockout Tagout
- Lockout Tagout Safety Catalogue (Download)
- Lockout Tagout Newsletter
- Lockout Tagout Blog
- HSE Video On Lockout Tagout
- Lockout Tagout Presentation
- Lockout Tagout News
- Datasheets
- Lockout Tagout Devices Videos <How to operate>



Visit www.lockouttagoutprocedures.co.uk today for more information.

Mechanical Risk: Cylinder & Pneumatic Lockouts



Cylinder Tank Lockout

- Used to lockout cylinder tanks, including propane tanks on forklift trucks and stand alone propane tanks
- Valve stem hole is 31.5 mm in diameter
- Apply with ease to prevent access to the valve handle
- Designed to fit in tight spaces
- **2 padlocks can be applied**
- Max.shackle diameter: 6.5 mm
- Min.shackle clearance: 20 mm
- Packaging: 1 piece



Order Ref.	Description
046139-BR	Cylinder Tank Lockout



Gas Cylinder Lockout

- Prevents access to the main cylinder valve
- No need to match your lockout device to varying diameters and threads of cylinder caps
- Accommodates neck rings up to 88 mm diameter
- Install in seconds to save time
- **1 padlock can be applied**
- Max.shackle diameter: 7 mm
- Min.shackle clearance: 20 mm
- Packaging: 1 piece



Order Ref.	Description
045629-BR	Gas Cylinder Lockout



Pneumatic Quick-Disconnect Lockout

- Isolates pneumatic energy without the expense and inconvenience of installing in-line lockout valves
- Device is applied to the male fitting, isolating equipment from all compressed air sources
- Accommodates the majority of 6 mm, 9 mm and 12 mm male fittings
- Hole in centre of device allows for permanent storage on air hose and a loop on the side can be used to hang the hose and lockout device
- Max.shackle diameter: 6.5 mm
- Min.shackle clearance: 20 mm



Order Ref.	Description	Packaging
064221-BR	Pneumatic Lockout	1 piece
065645-BR	Pneumatic Lockout	6/pk



Combine Pneumatic Quick-Disconnect Lockouts with Safety Padlocks (page 30)

Mechanical Risk: All Purpose Lockout & Covers

Pneumatic Lockout - All Purpose

Prevents pneumatic fitting from being connected to pressurized air source

- Fits virtually all male pneumatic fittings found in manufacturing facilities
- Stainless steel construction for corrosion resistance
- Measures 3.5 cm wide x 19.7 cm tall x 0.3 cm thick
- Accepts any Master Lock® or American Lock® Safety Padlock
- Works with lockout hasps for multiple worker lockout.



Order Ref.	Description
S3900-ML	Stainless Steel Pneumatic Lockout

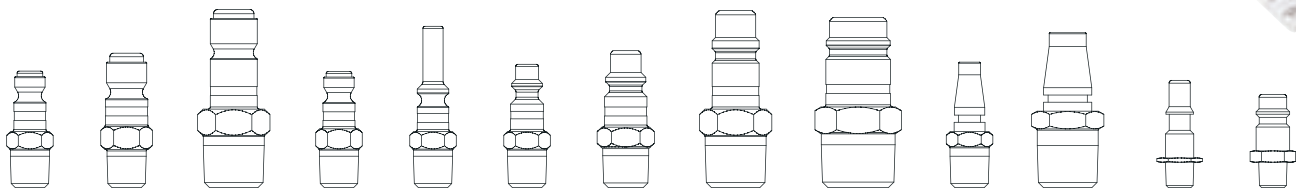

Steering Wheel Covers

Provides Visual Deterrent for Vehicle Maintenance

- Three sizes available for various diameter steering wheels – 46.6 cm, 50.8 cm and 61 cm
- Trilingual warning notifies employees not to start or move vehicle
- Lock in place with a 421-ML hasp and safety padlock
- For added security, use Safety Series™ 8611-ML lockout cable around steering wheel and foot pedals.

Three sizes available

Order Ref.	Description
4716-ML	Small Steering Wheel Cover
4720-ML	Medium Steering Wheel Cover
4724-ML	Large Steering Wheel Cover

Ø 40.6 cm
Ø 16"

4716-ML



Ø 50.8 cm
Ø 20"

4720-ML



Ø 61 cm
Ø 24"

4724-ML





Popular on Forklift Trucks

These steering wheel covers are available in various sizes and are ideal for locking out and tagging out forklift trucks. Visit our website for more information.



Large Electrical/Pneumatic Lockout

- Accommodates a large variety of electrical plugs up to 89 mm diameter and 127 mm in length as well as male air hose connectors
- Works on 110V, 220V and 550V plugs
- Made of Polystyrene material
- **4 padlocks can be applied**
- Max. shackle diameter : 7 mm
- Min. shackle clearance: 20 mm
- Packaging: 1 piece

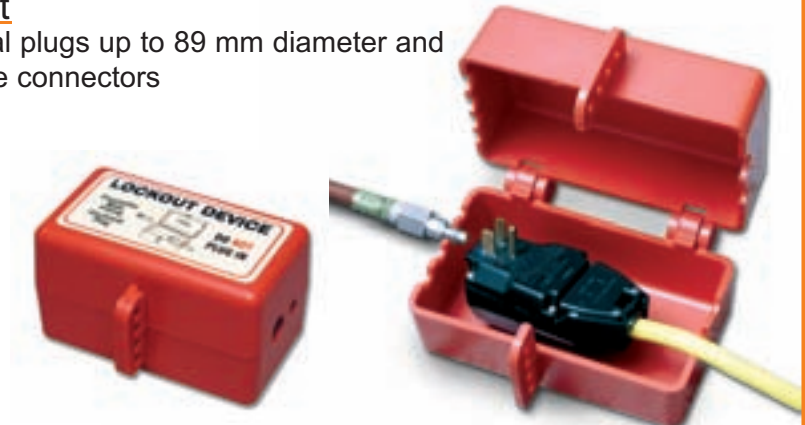

Order Ref.	Description
800126-BR	Large Electrical/Pneumatic Lockout

Lockout Devices for Plug Connections

- Especially developed to secure all types of plugs
- Highly effective against the unauthorised or incorrect use of electrical equipment
- Simple to use
- Max. shackle diameter: 7 mm
- Min. shackle clearance: 20 mm
- Packaging: 1 piece

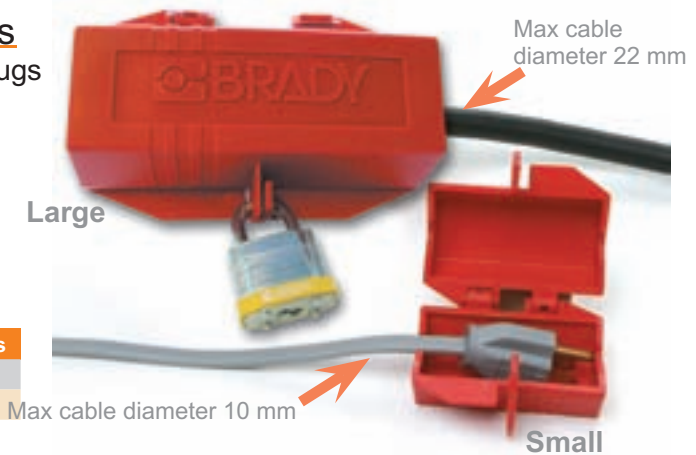

Order Ref.	Type	Dimensions (mm)	Lock holes
065674-BR	Small	50 x 50 x 90	2
065675-BR	Large	80 x 80 x 180	4

Order Ref.	Size in mm										
	A	B	C	D	E	F	G	H	I	J	K
065674-BR	18	50	12	18	52	18	42	45	43	15	81
065675-BR	25	90	16	40	97	40	70	85	76	25	167

Hubbell Plugout for Industrial Plug Connections

- Effectively secures all industrial plug connections
- Available in two sizes:
 - Small:** connections with a max. diam. 7 cm / length of 12 cm / max. cable diam. 25 mm
 - Large:** connections with a max. diam. 11.5 cm / length of 25 cm / max. cable diam. 35 mm
- Max. shackle diameter: 7 mm
- Min. shackle clearance: 20 mm
- Packaging: 1 piece



Order Ref.	Type	Plug diameter	Plug length	Cable diameter
065695-BR	Small	7 cm	12 cm	25 mm
065968-BR	Large	11 cm	25 cm	35 mm

Order Ref.	Size in mm															
	A	B	C	D	E	F	G	H	I	J	K	L	M	N	O	P
065695-BR	15	76	15	20	10	125	30	20	36	20	80	106	30	145	120	70
065968-BR	-	-	-	15	-	285	15	18	125	18	120	120	-	286	290	120

Electrical Risk: Plug Lockouts

Electrical Plug Lockout

Outward/Inward Rotation Allows for Easier Application & Storage

- Surrounds the electrical plug; protects against accidental reconnection
- Unique, patent-pending rotating design allows for easier installation in confined space applications
- Complete with high-visibility permanent safety labels (English, French & Spanish). Labels can be written-on to identify the responsible person, then erased for the next job
- Tough, lightweight, dielectric Zenex™ thermoplastic bodies withstand chemicals; perform effectively in extreme conditions (temperature range -47°C to +177°C).

Order Ref.	Description	Dimensions
487-ML	Electrical Plug cover small – 120 and 240 volt plugs	10 x 11 x 7 cm
488-ML	Electrical Plug cover large – 240 and 250 volt plugs	19 x 13 x 9 cm



Small Electrical Plug Lock-out



Order Ref.
S2005-ML

Compact design locks out smaller plugs easily & effectively

- Locks on the US prongs of 110-120 volt plugs
- Fits 2 prong plugs with and without earth.

Push Button and Rotary Switch Cover

- Prohibits access to a switch or control
- Fits both 30.5mm and 22.5mm diameter switches
- Clear bases and cover allow visibility of nameplates and labels
- Master carton qty 1. Commercial packaging.
- Patents pending



Order Ref.	Description
S2151-ML	Removable Push Button and Rotary Switch Cover
S2153-ML	Permanent Push Button and Rotary Switch Cover

Oversized Plug & Hoist Control Cover

Effectively locks out all sizes or large electrical connectors and hoist controls

- Patent pending lockout, the cinch sack offers broad application solutions
- Insert PVC tubing to block access to hoist control buttons
- Lock out with up to 6 padlocks or hasps.



Order Ref.	Description	Dimensions
453L-ML	Nylon Oversized Plug & Control Lockout	482 x 165 mm
453XL-ML	Nylon Oversized Plug & Control Lockout	660 x 254 mm
453XXL-ML	Nylon Oversized Plug & Control Lockout	914 x 356 mm

Zenex™ is a registered trademark of Master Lock®.

Electrical Risk: Circuit Breaker Lockouts



Universal Multi-Pole lockout works with most two or three pole breakers utilising a tie-bar.

Universal Multi-Pole Breaker Lockout

- Made of durable impact-modified nylon
- Compatible with GE, ITE, Sylvania, Challenger, Bryan, Westinghouse, General Switch Co. ...
- Use thumbscrews to clamp lockout securely over tie bar, then insert lock to prevent clamp from being loosened
- Max. shackle diameter: 7 mm
- Min. shackle clearance: 20 mm



Order Ref.	Packaging
066321-BR	1 piece
066320-BR	6/pk



Combine Circuit Breaker Lockouts with Safety Padlocks (page 30)

Economy Multi-Pole Breaker Lockout

- Economical solution!
- Designed to fit multi-pole breakers
- Quick and easy to apply
- Max. shackle diameter: 7 mm
- Min. shackle clearance: 20 mm



Order Ref.	Description
805814-BR	Economy Multi-Pole Breaker Lockout



Single Pole Circuit Breaker Lockout

- Designed for breakers that have holes in the switch tongue
- Quick and easy – just snap in place and apply lock
- Dual cavities accommodate different size switch tongues
- Dimensions (H x L x W): 21 x 9 x 55 mm
- Max. shackle diameter: 7 mm
- Min. shackle clearance: 20 mm



Order Ref.	Packaging
065387-BR	1 piece
065688-BR	6/pk

“No Hole” Circuit Breaker Lockout

- Extremely versatile – works on wide range of single-pole and internal-trip multi-pole breakers
- 2 sizes: one for 120-277V breakers and one for 480-600V breakers
- Made of rugged polypropylene and glass filled impact modified nylon
- Use thumbscrews to damp lockout securely onto switch tongue, then pull cover over thumbscrew and lock in place to prevent clamp from being loosened
- Max. shackle diameter: 7 mm
- Min. shackle clearance: 20 mm



Order Ref.	Description	Max. Switch width	Packaging
065396-BR	277 Volt Device	38 mm	1 piece
065965-BR	277 Volt Device	38 mm	6/pk
065397-BR	480-600 Volts Device	16 mm	1 piece
065966-BR	480-600 Volts Device	16 mm	6/pk

How to apply:



Covering a breaker with a piece of duct tape to “lock it out” isn’t safe or effective and certainly doesn’t satisfy legislation. A lockout device gives you a new level of safety and compliance.

Electrical Risk: Circuit Breaker Lockouts

Miniature Circuit Breaker Lockouts

- Mini Circuit Breaker Lockout to safely and effectively lock all European equipment
- The Mini Circuit Breaker Lockout is simple to use and quick to apply
- Works with all Master Lock Safety padlocks and lockout hasps.

Rapid Delivery



S2390-ML

Fits breaker with toggle openings 11mm or less



S2391-ML

Fits breakers with toggle openings over 11mm

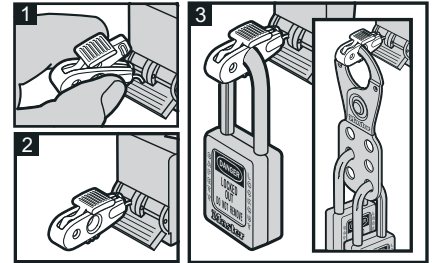

MCB-NOTOOL

Universal "No Tool" Circuit Breaker Lockout



This convenient solution universally fits miniature circuit breakers and can be easily applied to the toggle by tightening the screw.



S2392-ML



Fits breaker with pin-in toggles

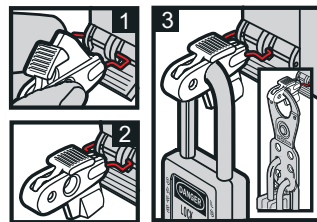

S2393-ML

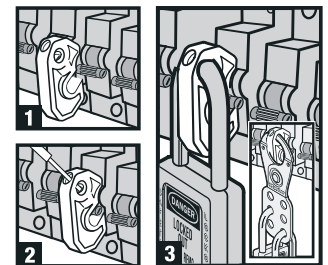

Circuit Breaker Lockout Kit

An Ideal Lockout Kit for personal use by electricians – a must have in their toolkit!

Each kit contains a variety of safety products essential to ensure an individual can safely 'lockout' on the job e.g non-conductive padlocks and lockout hasps, a variety of circuit breaker lockouts compatible with most circuit breakers on the market, safety tags etc.



KITELEC-SF09-ML



Large Order? Call for Quote!

Order Ref.	Description	Dimensions
S2390-ML	Circuit Breaker Lockout	5 x 11 x 1 mm
S2391-ML	Circuit Breaker Lockout	5 x 11 x 1 mm
S2392-ML	Circuit Breaker Lockout	5 x 11 x 1 mm
S2393-ML	Circuit Breaker Lockout	10 x 44 x 25 mm
S2300AST-ML	Contains 4 - S2390-ML; S2391-ML; S2392-ML; S2393-ML Mini Circuit Breakers	
KITELEC-SF09-ML	Contains 2 – 406KARED-ML non conductive padlocks; 1- S2300AST-ML Kit; 1- 428-ML Zenex™ hasp; 1- S430-ML hasp; 1- 493B-ML Circuit Breaker Lockout; 2- 497ABLC-ML tags ⁽¹⁾	
MCB-NOTOOL	"No Tool" Circuit Breaker Lockouts install quickly and easily without any tools. Featuring a compact universal design.	

Electrical Risk: Circuit Breaker Lockouts



Oversized Breaker Lockout Device

- Oversized 480/600Volt frame lockout, fits breakers up to 63.5 mm wide by 22.2 mm thick
- Max. shackle diameter: 7 mm
- Min. shackle clearance: 20 mm



Order	Ref.	Packaging
065329-BR		1 piece
065321-BR		6/pk



480-600V Breaker Lockout

- Perfect for locking out oversized and irregularly shaped switches
- Self-adhesive backed rails are permanently installed onto an electrical panel
 - simply clean panel surface and adhere – no drilling required!
- Blocking bars (red and green) are 190 mm long
- Red bar = indicates locked “off”
Green bar = indicates locked “on”
- Max. shackle diameter 6.5 mm
- Min. shackle clearance: 20 mm



Breaker Blocker Kit

Order Ref.	Description
090891-BR	Breaker Blocker Kit includes: 2 yellow mounting rails, 1 red blocking bar, 1 green blocking bar and 3 alcohol wipes.



Breaker Blocker Components

Order Ref.	Description	Packaging
090892-BR	190 mm Red Blocking Bar	5/pk
090893-BR	190 mm Green Blocking Bar	5/pk
051264-BR	101 mm Yellow Mounting Rails	2/pk
051265-BR	Blocking Bar Holder	5/pk



Blocking Bar Holder

Circuit Breaker Lockout - UFL2

- Locks out most types of fuse holders - One size fits all
- Locks out 20 Amp to 400 Amp fuse holders
- Made from sturdy nylon plastic
- Dimensions: 60x35x15mm wide
- 8mm padlock hole - Max. clamping 5mm



Order Ref.
UFL2



Electrical Risk: Circuit Breaker Lockouts

Popular Product



Pin-Out Standard (POS)



Tie-Bar (TBLO)



Pin-Out Wide (POW)



Pin-In Standard (PIS)

Rapid Delivery

Brady Miniature Circuit Breaker Lockout

- A safe and effective method for locking out European Circuit Breakers.
- Will fit most existing types of European Circuit Breakers.
- Miniature Breaker Lockout unique in its kind = requires NO TOOLS to install! The Lockout easily installs with the aid of a Push Button. The Tie Bar Style Lockout has a convenient thumb wheel for quick application.
- Available for single and multi-pole breakers.
- Recommended to use in combination with a padlock for added safety. The lockouts can take padlocks with a shackle diameter up to 6 mm

Material: glass-filled nylon

Each of these Breaker Lockouts are available in single pack or 6-pack

Order Ref.	Type	Packaging
090844-BR	POS	1
090845-BR	POS	6
090847-BR	PIS	1
090848-BR	PIS	6

Order Ref.	Type	Packaging
090850-BR	POW	1
090851-BR	POW	6
090853-BR	TBLO	1
090854-BR	TBLO	6



Demo-kit

If you are uncertain about which pin you need, you can order our demo-kit which contains one example of each type of Miniature Breaker Lockout.

Order Ref.
805853-BR

Breaker Compatibility Chart

Brand	Poles	Model No.	Order Ref.	Type	Brand	Poles	Model No.	Order Ref.	Type
ABB	1	S222	090844-BR	POS	Legrand	4	01980	090844-BR	TBLO
ABB	1	F374	090844-BR	POS	Legrand	2	04302	090847-BR	PIS
ABB	1	S251, S261, S263	090844-BR	POS	Legrand	3	06469	090847-BR	PIS
ABB	1	S272, S253	090844-BR	POS	Legrand	1	01908	090844-BR	POS
ABB	3	S253	090844-BR	POS	Merlin Gerin	3	C80A	090850-BR/090853-BR	TBLO/POW
AEG	2	E82S	090847-BR	PIS	Merlin Gerin	2	B100A	090850-BR/090853-BR	TBLO/POW
Allen-Bradley	1,2,3	1492-CB1, 2, 3	090844-BR	POS	Merlin Gerin	1	C60N	090844-BR	POS
Buschmat	1	S46	090844-BR	POS	Merlin Gerin	1	C32N	090844-BR	POS
Clipsal	1	4CB116	090844-BR	POS	Merlin Gerin	2	C60N	090844-BR	POS
Clipsal	3	4CB320	090844-BR	POS	Merlin Gerin	4	C60N	090844-BR	POS
E-T-A	1	911225	090847-BR	PIS	Merlin Gerin	3	C32N	090844-BR	POS
E-T-A	2	911220G	090844-BR	POS	Merlin Gerin	3	C45AD	090844-BR	POS
FAZ	4	C16	090844-BR	POS	Proteus	1	C16	090844-BR	POS
FAZ	1	C16	090844-BR	POS	Proteus	1	C6	090844-BR	POS
GE Vynckier	3	Series E	090847-BR	PIS	Proteus	3	C6	090844-BR	POS
GE Vynckier	3	Series G	090847-BR	PIS	Siemens 17U	2	5SQ12	090853-BR	TBLO
GE Vynckier	4	Series E	090847-BR	PIS	Siemens 17U	3	5SQ13	090853-BR	TBLO
GE Vynckier	1	Series G	090847-BR	PIS	Siemens 17U	4	5SQ16	090853-BR	TBLO
GE Vynckier 16A	2	Series E	090847-BR	PIS	Siemens 17U	1	5SQ11	090850-BR	POW
GE Vynckier C16, 16A	1	Series E	090847-BR	PIS	Siemens C10	1	5SX1	090850-BR	POW
Hager	3	453717	090844-BR	POS	Siemens C32	2	5SX1-2	090853-BR	TBLO
Hager	2	MW216A	090844-BR	POS	Siemens C70	3	5SX13	090853-BR	TBLO
Hager	4	MW620A	090844-BR	POS	Siemens L20A	2	5SN2-2	090853-BR	TBLO
Kapp	1	LS68	090844-BR	PIS	Sursum	3	Ea53	090847-BR	PIS
Legrand	2	01935	090844-BR	TBLO	Wylex	2	WRS40/2	090844-BR	POS
Legrand	3	01980	090844-BR	TBLO					

Electrical Risk: Circuit Breaker Lockouts

Master Lock® offers innovative, devices for the effective lockout of electrical shut-off points, including circuit breakers, electrical plugs and wall switches.

Grip Tight Circuit Breaker Lockout

Greatest Hold Strength Combined with Universal Fit

- Secure and simple mounting for a solid lockout. Grips tight with simple thumb screw and clamping handle
- Exclusive design accommodates virtually all styles of breaker toggles
- Narrow profile permits side-by-side breaker lockout
- Both devices accept all American Lock® safety and Master Lock® padlock shackle and lockout hasp diameters
- Durable construction with powder coated steel and reinforced polymer allows operation in harsh environments.

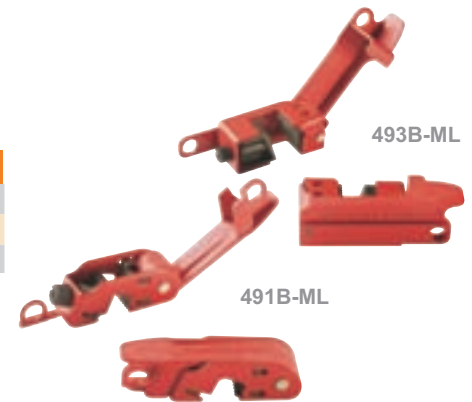

Order Ref.	Description	Dimensions
491B-ML	Circuit Breaker Lockout - tall and wide toggles	7 x 13 x 2 cm
493B-ML	Circuit Breaker Lockout - std. single and double toggles	7 x 13 x 3 cm
506-ML	Set of each device - one 491B-ML and one 493B-ML	



Circuit Breaker Switch Padlock

Provides the Flexibility to Effectively Lock Out Breaker Switches

- 0.5 cm diameter cable shackle allows padlock to properly lock all types of circuit breaker lockout devices
- Flexible cable allows the compact lock body to be positioned so that the control panel door closes properly
- Fits the tight space constraints within circuit breaker shutoff boxes.

Order Ref.
7C5RED-ML

Universal Wall Switch Lockout

Locks Out Both Toggle and Decora Paddle Wall Switches

- Patent-pending design assures switch is locked on or off
- Hinges open for unobstructed normal operation of switch.

Order Ref.
496B-ML



Paddle Switch

Toggle Switch



PRO-LOCK II® Cable Lockout
Lockout Tagout Safety Ltd® offers a variety of cable lockout devices that can be used for locking out electrical installations

Lockout Kits: Ultimate Lockout Kit

Ultimate Lockout Kit

This is our most extensive Lockout Tagout kit and includes everything a larger company might need for their Lockout Tagout programme as well as training material.

Content:

- Large Universal Valve Lockout base clamping unit
- Large blocking arm
- Cable attachment
- Adjustable gate valve device
- APCLO with sheathed metal cable
- Large plug lockout device
- Red butterfly valve lockout
- Cylinder tank lockout
- Gas cylinder lockout
- Mini cable lockout
- 227 V no hole circuit breaker
- 480-600V no hole circuit breaker
- 480-600V Breaker blocker kit
- Miniature circuit breaker demo kit (1 of each type)
- Economy multipole breaker
- Nylon lockout hasp
- 1 pack of red safety padlocks
- 25 mm red safety lockouts (1 pack)
- Duffel bag
- DVD - 9 basic steps
- DVD - Lockout for life
- "Do not operate" tag 75 x 160 mm
- Large lockout pouch
- Lockout belt pouch
- Pen

Order Ref.
806178-BR



Industrial No1 Choice



Lockout Tagout Safety Ltd Newsletter



We produce a monthly newsletter for our customers so that you can keep up-to-date with the latest developments in industrial legislation.

It includes access to a range of articles which highlight health and safety myths and the best ways to ensure the industrial workplace is safe for both employees and employers. There are also details of **exclusive special offers** so make sure to scan this QR code or email us for more information.



Lockout Kits: Personal Lockout Pouches

Personal Lockout Pouches

Custom
Option
Available

Padlocks and Devices for Individual Workers

- Zipped pouch is easy to carry or wear with adjustable waist strap
- Make your own personal pouch and select your padlock: Zenex™, Aluminum or Steel.
- Two kits available, one designed with an electrical lockout focus, the other for general maintenance.

Order Ref.	Description
1456E406KA-ML	Contains: 2 – 406-ML Keyed Alike Padlocks; 1 – S2390-ML Mini Circuit Breaker; 1 – S2391-ML Mini Circuit Breaker; 1 – S2392-ML Mini Circuit Breaker ; 1 – S2393-ML Mini CircuitBreaker ; 1 – 493B-ML Circuit Breaker Lockout ; 1 – 428-ML Hasp; 1 - S430-ML Hasp ; 2 - 497ABLC-ML Tags*

*Available in 11 languages



1456P410KA-ML



1456E406KA-ML



1456E3-ML

410RED Zenex™ Padlock	3RED Steel Padlock	Description
1456E410-ML	1456E3-ML	Electrical Lockout Focus. Contains: 1 – Padlock; 1 – 7C5RED-ML Breaker Switch Padlock; 1 – 420-ML Hasp; 2 pcs – 493B-ML, 1 pc – 491B-ML Circuit Breaker Lockouts; 1 pack of 12 x 497A-ML Tags
1456P410KA-ML	1456P3KA-ML	Padlocks & Tags. Contains: 3 – Padlocks Keyed Alike; 1 – 420-ML Hasp; 1 pack of 12 x 497A-ML Tags

Series Compliance Centres

Zipped Binder Keeps Important Papers Organized Whilst Keeping Dirt and Grime Out

- Use for MSDS, Lockout Procedures, Right-To-Know, ISO procedures and many others
- Front window allows you to customize to your needs. Includes MSDS, Lockout Procedures, Right-To-Know in English, Spanish/English, and French/English
- Available with or without Wall Mounting Bracket.

Order Ref.	Description
S315-ML	One 3.8 cm with wall bracket/sign
S316-ML	One 3.8 cm binder (no wall bracket/sign)
S317-ML	Two 3.8 cm binders with one wall bracket/sign
S330-ML	One 7.6 cm binder with wall bracket/sign
S331-ML	One 7.6 cm binder (no wall bracket/sign)



S331-ML

S315-ML

S317-ML

Zenex™ is a registered trademark of Master Lock.®

Lockout Kits: Personal Lockout Kits

Personal Lockout Kit

Electrical, Valve and Combined Lockout/Tagout Organizers

- Make your own kit and select your padlock: Zenex™, Aluminum or Steel.
- Safety lockout carrying case keeps important lockout devices and padlocks together
- Kits include high-use components, satisfying most lockout applications
- Personal kits are for an individual worker; padlocks are supplied keyed-alike for added convenience.



Electrical and Valve

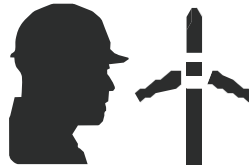

Renewable No1 Choice



Electrical



Mechanical and Valve



410RED Xenoy® Padlock	Description
1457E410KA-ML	Electrical Lockout Focus. Contains: 3 – Padlocks; 1 – 7C5RED-ML Circuit Breaker Padlock; 1 – 420-ML Hasp; 1 – 427-ML Snap-On Hasp; 2 pc – 491B-ML, 3 pc – 493B-ML Circuit Breaker Lockouts; 1 pc – 496B-ML Wall Switch Lockout; 1 pack of 12 x 497A-ML Tag.
1457V410KA-ML	Valve Lockout Focus. Contains: 3 Padlocks; 1 – 420-ML Hasp; 1 – 427-ML Snap-On Hasp; 1 – 8611-ML Adjustable Cable Lockout; 1 – 480-ML, 1 – 481-ML & 1 – 482-ML Gate Valve Covers; 1 – 468L-ML Ball Valve Cover & 1 - S3068-ML; 1 pack of 12 x 497A-ML Tag.
1457VE410KA-ML	Electrical & Valve Lockout Focus. Contains: 3 – Padlocks; 1 – 7C5RED-ML Circuit Breaker Padlock; 1 – 420-ML Hasp; 1 – 427-ML Snap-On Hasp; 1 – 8611-ML Adjustable Cable Lockout; 1 – 480-ML, 1 – 481-ML & 1 – 482 Gate Valve Covers; 1 – 468L-ML Ball Valve Cover & 1 – S3068-ML; 2 pc – 491B-ML, 3 pc – 493B-ML Circuit Breaker Lockouts; 1 pc – 496B-ML Wall Switch Lockout; pack 1 of 12 x 497A-ML Tag.

Custom Lockout Kits

As the safety needs of each worker within a company can vary, Lockout Tagout Safety Ltd, provide a custom lockout kit option. This allows personalised pouches/bags to be created containing only the useful aspects of an 'off-the-shelf' kit specific to your workplace. See [page 26](#) for more details.

Zenex™ is a registered trademark of Master Lock.®

Master Lock® Group Lockout Kit

Modular Lockout/Tagout Organizers

- Make your own kit and select your padlock: Zenex™, Aluminum or Steel.
- Lightweight safety lockout carrying case, 381 mm (l) x 241 mm (H) x 178 mm (W), with modular, translucent storage compartments for improved organization and fast component selection
- Separate compartments for effective grouping of (1) padlocks & hasps, (2) valve lockout & (3) electrical lockout components
- Group kits are for multiple workers; padlocks are supplied keyed-different, to ensure that no employee can open a colleague's padlock
- PLUS, a free of charge Safety Lockout Padlock Key Charting System is available to you. Simply return the enclosed mail-in card after your purchase. Master Lock® will supply a Registered System number, maintain a record of the padlock key cuts provided with your station and ensure that there is no unwanted padlock key cut duplication on your future orders – this is critical for Safety Lockout!

Electrical and Valve



Electrical



Valve



410RED Xenoy® Padlock	Description
1458E410-ML	Electrical Lockout Focus. Contains: 6 – Padlocks; 2 – 7C5RED-ML Breaker Switch Padlocks; 1 – 420-ML Hasp; 1 – 427-ML Snap-On Hasp; 1 – 8611-ML1 Adjustable Cable Lockout; 1 – 487-ML & 1 – 488-ML Plug Covers; 4 – 493B-ML & 1-S3068-ML, 2 – 491B-ML Circuit Breaker Lockouts; 2 pcs– 496B-ML Wall Switch Covers; packs 2 of 12 x 497A-ML Tag
1458V410-ML	Valve Lockout Focus. Contains: 6 Padlocks; 1 – 420-ML Hasp; 1 – 427-ML Snap-On Hasp; 1 – 8611-ML Adjustable Cable Lockout; 1 – 480-ML, 1 – 481-ML, 1 – 482-ML & 1 – 483-ML Gate Valve Covers; 2 – 468L-ML Ball Valve Covers; 2 packs of 12 x 497A-ML Tag
1458VE410-ML	Electrical & Valve Lockout Focus. Contains: 6 – Padlocks; 2 – 7C5RED-ML Breaker Switch Padlocks; 1 – 420-ML Hasp; 1 – 427-ML Snap-On Hasp; 1 – 8611-ML Adjustable Cable Lockout; 1 – 487-ML & 1 – 488-ML Plug Covers; 1 – 480-ML, 1 – 481-ML & 1 – 482-ML Gate Valve Covers; 1 – 468L-ML Ball Valve Cover & 1-S3068-ML; 6 pcs – 493B-ML, 3 – 491B-ML Circuit Breaker Lockouts; 2 – 496B-ML Wall Switch Covers; 2 packs of 12 x 497A-ML Tag

Zenex™ is a registered trademark of Master Lock.®

T: 01642 244017

Web Ordering : www.LockoutTagout.co.uk

Lockout Kits: Brady Lockout Kits



Small Adjustable Lockout Kit

Content:

- Large lockout pouch
- Adjustable gate valve device
- APCLO with sheathed metal cable
- 2 red safety padlocks
- 2 red safety lockouts (25 mm)
- Small Universal Valve Lockout base clamping unit
- Small blocking arm
- Pen
- "Do not operate" tag 75 x 160 mm

Order Ref.
806176-BR

Gate Valve Lockout Kit

Content:

- 25-64 mm red gate valve lockout
- 64-127 mm red gate valve lockout
- 127-165 mm red gate valve lockout
- 165-254 mm red gate valve lockout
- 254-320 mm red gate valve lockout
- Red lockout satchel
- 1 pack of red safety padlocks
- "Do not operate" tag 75 x 160 mm



Order Ref.
806190-BR



Lockout Starter Kit

Content:

- Small UVLO base unit
- Small blocking arm for use with UVLO
- Cable for use with UVLO
- APCLO with sheathed cable
- 2 x safety padlocks
- Tag - blank
- Pen
- Large lockout pouch

Order Ref.
805877-BR

Custom Lockout Kits

As the safety needs of each worker within a company can vary, Lockout Tagout Safety Ltd, provide a custom lockout kit option. This allows personalised pouches/bags to be created containing only the useful aspects of an 'off-the-shelf' kit specific to your workplace. A variety of padlocks, tags, hasps and other specialised safety equipment may be included in these kits.

For more information on how to build your own custom lockout kit please call 01642 244017 or email us at info@lockout-tagout.co.uk and let us know which equipment you require. If you are unsure as to which equipment you may need to comply with safety legislation, we can arrange on-site visits to give you some advice.





Large Order? Call for Quote!

5 Steps to help you choose the locks you need

1. Define which type suits best the application, use the below chart to help you out.
2. Define height and diameter of shackle (you will find this info with each lockout tagout device in this catalogue)
3. Choose a key system: Keyed Different, Keyed Alike, Master Keyed.
4. Choose the colour of the padlock.
5. Decide if the lock needs to be engraved or not.

Choose the lock that's best suited for the job!

	Safety Padlock	Brass Padlock	Aluminium Padlock	Steel Padlock
Compact, lightweight	✓	✓	✓	
Nonconductive body & keyway	✓			
Most corrosion resistant	✓	✓		
Most spark resistant	✓	✓		
Most tamperproof	✓		✓	
Most rugged			✓	✓
Custom keying	✓		✓	✓
Engraving*	✓	✓	✓	✓

*Only available as custom

Keying & Charting Options

Keyed Different

Padlocks are usually supplied “keyed differently” when purchased from stock.

This means that the key for one lock should not open another. These padlocks use 5- or 6-pin cylinders to offer high levels of safety and security. Both cylinders and keys

are precision-machined to exacting standards. This enables us to offer a greater number of unique keys than other locks with the same number of pins, making it highly unlikely that you will ever receive a duplicate lock. To guarantee that each lock is different, we can chart your locks, ensuring that each padlock you receive is different from the others.

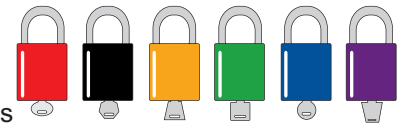

Keyed Alike

When keyed alike, all locks in a set can be opened with the same key. This option is beneficial when multiple locks are assigned to a single employee.

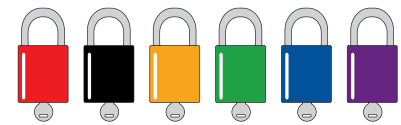

Master Keyed

A master key can be used to open multiple locks that are keyed differently.

This allows supervisors to easily remove a lock in the event of an emergency.

In order for employees to retain exclusive control, master keys should be kept in a secure location that is accessible only to management.

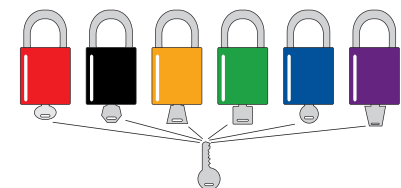

Grand Master Keyed

The master key system can be extended to several teams. This way each team has a master key and all the locks of all the teams can be opened by a ‘Grand’ Master Key if necessary.

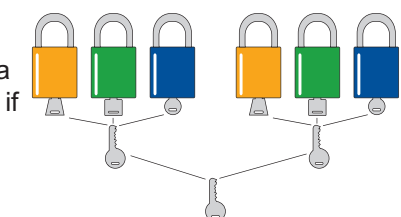

Locks, Hasps & Accessories: Padlocks

Zenex™ Safety Padlocks

Optimal safety padlock designed exclusively for Lockout/Tagout. Distinctive Zenex™ Safety padlock is durable, standardized, substantial and identifiable for OSHA 1910.147 compliance. Stands up to chemicals, temperature extremes and is UV stable.

Zenex™ is a registered trademark of General Electric Corporation.



- Temperature tested from -47° to 177° C
- Excellent Chemical resistance
- Excellent corrosion resistance
- UV stable
- No silicone used in padlock
- Over 101,000 unique safety key codes available
- Over 1 million possible codes with optional key cylinders
- Keyed Different, Keyed Alike and Master Keyed options
- Key retaining – ensures padlock is not accidentally left unlocked
- Includes one key to ensure compliance with OSHA guideline of «1 employee, 1 padlock, 1 key»
- Available in 8 colours
- Body sides and face can be laser engraved for permanent identification
- Sealed keying system ensures your safety lockout system stays pure by preventing haphazard rekeying and the accidental introduction of duplicate key codes.

S31-ML - Zenex™ Lock-out Padlock



S31-ML

- The new S31-ML is Key Retaining (must be locked to remove key)
- The 4.7mm Stainless Steel Shackle is perfect for confined spaces
- Choice of 9 Colours
- The new S31-ML includes labels in English, French and Spanish
- Can be customised by laser engraving for a more durable and permanent identification
- Ideal for lockout with its 4.7 mm diameter Stainless Steel shackle.
- It is tough, lightweight and compact; made from chemical resistant engineered plastic
- Choice of either 38mm or 76mm tall shackle



Industrial No1 Choice

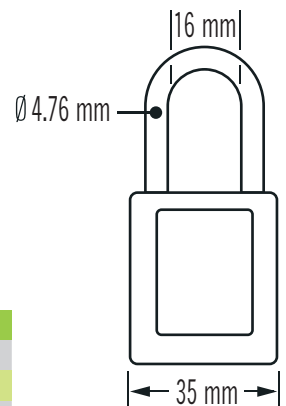

Order Ref.	Description
S31-ML	Zenex™ Padlocks - Stainless Steel Shackle - Key Retaining
S31LT-ML	Zenex™ Padlocks - Stainless Steel Shackle - Long Shackle - Key Retaining
S32-ML	Zenex™ Padlocks - Composite Shackle - Key Retaining
S33-ML	Zenex™ Padlocks - Stainless Steel Shackle - No Key Retaining
S33LT-ML	Zenex™ Padlocks - Stainless Steel Shackle - Long Shackle - No Key Retaining

Zenex™ is a registered trademark of Master Lock.®

Locks, Hasps & Accessories: Padlocks

410-ML - Zenex™ Safety Padlock

- Zenex™ body with 6 mm dia. plated metal shackle for corrosion resistance
- Available with 25, 38 or 76 mm tall shackle
- Includes write-on “Danger” and “Property of” labels in French, English, and Spanish. Other languages available.

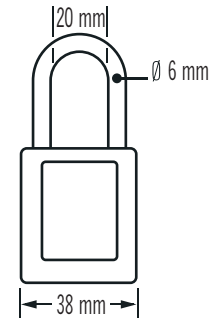

Order Ref.	Description	Vertical Shackle
410-ML	Keyed Different	38 mm
410LT-ML	Keyed Different Extra Length Shackle	76 mm
410KA-ML	Keyed Alike	38 mm
410KALT-ML	Keyed Alike, Extra Length Shackle	76 mm
410MK-ML	Master Keyed	38 mm
410KAMK-ML	Keyed Alike Master Keyed	38 mm
	Rainbow Color Assortment Packs	
410AST-ML	One each of all eight 410-ML colors, Keyed Different	38 mm

8 Color Options: Add desired Colour Suffix



411-ML - Zenex™ Safety Padlock

- Tall Zenex™ body with 6mm dia. plated metal shackle for corrosion resistance
- Available with 38 mm or 76 mm tall shackle
- Includes bilingual “Danger” and “Property of” labels in English/Spanish and English/French. Other languages are available
- Available with ID-photo.

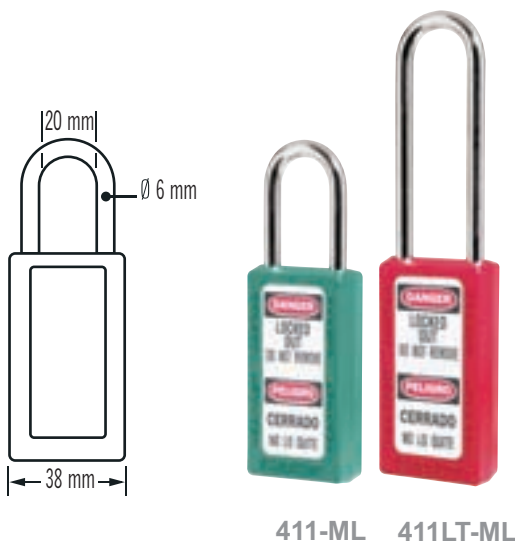

Order Ref.	Description	Vertical Shackle
411-ML	Keyed Different	38 mm
411LT-ML	Keyed Different Extra length Shackle	76 mm
411KA-ML	Keyed Alike	38 mm
411KALT-ML	Keyed Alike, Extra length Shackle	76 mm
411MK-ML	Master Keyed	38 mm
411KAMK-ML	Keyed Alike Master Keyed	38 mm
	Rainbow Color Assortment Packs	
411AST-ML	One each of all eight 411 colors, Keyed Different	38 mm

8 Color Options: Add desired Colour Suffix



Zenex™ is a registered trademark of Master Lock.®

Locks, Hasps & Accessories: Padlocks



406-ML

406-ML - Non-conductive Safety Padlock

- Non-conductive padlock: Shackle and Body with Zenex™ composite plastic
- Ideal for electrical lockout, confined spaces, medical, military and mining
- Shackle withstands over 136 kg pull
- Includes write-on "Danger" and "Property Of" labels in English, Spanish and French. Other languages available.

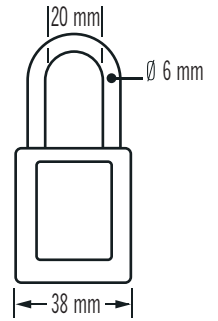

Order Ref.	Description	Vertical Shackle
406-ML	Keyed Different	38 mm
406KA-ML	Keyed Alike	38 mm
406MK-ML	Master Keyed	38 mm
406KAMK-ML	Keyed Alike Master Keyed	38 mm







8 Color Options: Add desired Colour Suffix



Brady® Safety Padlocks:

- Compact and lightweight
- Enhanced impact resistance
- Nonconductive, nonsparking body
- Ideal for electrical applications
- Ribbed design for easy gripping and handling
- Made of rugged reinforced nylon with hardened steel shackle
- Superior temperature, chemical and corrosion resistance
- Locks come standard with English, French and Spanish language labels
- **Locks are supplied keyed differently but custom keying is also available**
- One key supplied with each padlock

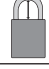

Dimensions		
		
38 mm	87 mm	16 mm
		
18.5 mm	38 mm	6.5 mm







Unique Cylinder Enhances Safety & Security!







- Patented insulated key chamber protects workers from shocks when key is inserted
- 6-pin precision-machined cylinder offers more unique key cuts, better tamper resistance
- Reserved, paracentric keyway provides optimal security
- Key won't release until padlock shackle is closed

6 Padlocks/Package	
Order Ref.	Colour
051344-BR	Blue
051339-BR	Red
051353-BR	Black
051346-BR	Yellow
051345-BR	Green
051347-BR	Orange
813636-BR	Brown
813637-BR	Violet
813638-BR	White

Padlock Bumpers	
Order Ref.	Colour
41/40 Bumper only	Black
41/40 Bumper only	Blue
41/40 Bumper only	Green
41/40 Bumper only	Orange
41/40 Bumper only	Purple
41/40 Bumper only	Red
41/40 Bumper only	White
41/40 Bumper only	Yellow

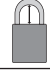

Order Ref.	Dimensions		
41/40HB50 C			
	44 mm	89.5 mm	26 mm
			
	18.5 mm	47 mm	7 mm

Order Ref.	Dimensions		
41/40			
	44mm	63mm	26mm
			
	18.5mm	20mm	7mm

41/40 Series ABUS Eterna Safety Padlocks

- Laminated steel padlock individually galvanised.
- Steel laminates, bottom most laminate hardened
- Laminates individually refined for optimum protection from corrosion rivets in the outer laminates compressed to protect against the rivet heads being knocked off
- Precision pin tumbler cylinder protected against drilling and leverage.
- Where to use it: medium security requirement the cylinder can be re-keyed to match an existing key
- Keyed alike Option Available.



Locks, Hasps & Accessories: Padlocks

72 Series Aluminium Padlocks

Solid aluminium body with hardened chrome-plated steel shackle





- Lightweight yet rugged
- Chemical and corrosion resistant
- 6-pin cylinder offers more unique key changes, tamper resistance
- **Locks are supplied keyed differently**
- **Custom keying and charting also available**
- Two keys supplied with each lock
- Designed to withstand rugged work environments



Chemical Industry No1 Choice



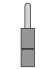
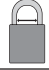
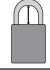



Aluminium Padlocks with 24.5 mm shackle

Order Ref.	Colour
72/40 KA TT00260	Black
72/40 KA TT60121	Blue
72/40 KA TT00590	Green
72/40 KA TT02767	Orange
72/40 KA TT02162	Red
72/40 KA TT60123	Yellow

Dimensions		
		
38 mm	73 mm	18 mm
		
20.5 mm	24.5 mm	7 mm

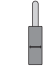
Aluminium Padlocks with 38 mm shackle

Order Ref.	Colour
72/40HB40 KA TT00260	Black
72/40HB40 KA TT60121	Blue
72/40HB40 KA TT00590	Green
72/40HB40 KA TT02767	Orange
72/40HB40 KA TT02162	Red
72/40HB40 KA TT60123	Yellow

Dimensions		
		
38 mm	86 mm	17 mm
		
20.5 mm	40 mm	7 mm



ABUS 83 AL/40 Series 2

- Available in 3 different colours
- Extra durable hardened steel shackle
- Fully **Key retaining**
- Can be keyed alike, master keyed or to differ
- Highly chemical and corrosive resistant

Order Ref.
83AL/40 S2 Red
83AL/40 S2 Blue
83AL/40 S2 Silver



Chemical Industry No1 Choice

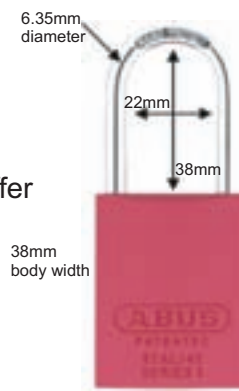

Brass Padlocks: Locks that will never rust!







Solid brass body and shackle

- Spark resistant ideal for use in flammable environments
- Corrosion resistant
- 6-pin cylinder offers more unique key cuts, better tamper resistance
- Locks protected by coloured vinyl sheaths
- **Locks are supplied keyed differently**
- Two keys supplied with each lock



Hydro-Plant No1 Choice

Order Ref.
T84MB/40 Black
T84MB/40 Blue
T84MB/40 Green
T84MB/40 Grey
T84MB/40 Red
T84MB/40 Yellow

Dimensions		
		
43 mm	59 mm	17 mm
		
20.5 mm	21.5 mm	6.5 mm

Locks, Hasps & Accessories: Padlocks

Abloy® Padlocks

ASSA ABLOY

Abloy® padlocks gain worldwide recognition due to strength secure design and build. Exceeding both European and Scandinavian standards (Scandinavian standards being most vigorous).

- Large Bodies provide physical strength
- Excellent drill protection
- Boron Steel Shackles
- Unrivalled Resistance to corrosion
- Ideal for the harshest environmental conditions
- Ideal for military and energy providers
- Surpasses all other padlocks for performance and security



Steel Padlock With Raised Shoulders (**ABLOY PL362**)

- For applications where maximum security is required.
- Case Hardened steel body with raised shoulders and top loaded cylinder provides the highest level of security and protection.
- This means it is virtually impregnable against attack by cutting and prying tools.
- Suitable for Military Applications, heavy sliding doors, train wagons, trucks, warehouses.
- PL342-AB is equipped with case hardened boron steel shackle, diameter 15 mm.
- The padlock body is manufactured from case-hardened steel and measures 72 mm wide.
- 25mm closed shackle meeting BS EN12320 Grade 6 and Scandinavian SSFN 014 Grade 5.
- All ABLOY® padlocks come with a 5 year warranty.

Order Ref.
PL362-AB

Brass Padlock (**ABLOY Padlock PL330-AB - Standard Shackle**)

- All purpose padlock of durable construction for storage doors, motor cycles, trailers, power station switches
- 25 mm shackle BS EN12320 Grade 3 and Scandinavian SSFN 014 Grade 2.
- The padlock body is brass and measures 48 mm wide.
- The shackle is 8mm in diameter made from case-hardened boron steel.



Order Ref.
PL330-AB



Brass Padlock (**ABLOY Padlock PL330/50-AB - Long Shackle**)

- All purpose padlock of durable construction for storage doors, motor cycles, trailers, power station switches
- 50 mm shackle
- BS EN12320 Grade 3 and Scandinavian SSFN 014 Grade 2
- The padlock body is brass and measures 48 mm wide.
- The shackle is 8 mm in diameter made from case-hardened boron steel.

Order Ref.
PL330/50-AB

Brass Padlock (**ABLOY Padlock PL330/100-AB Xtra Long Shackle**)

- All purpose padlock of durable construction for storage doors, motor cycles, trailers, power station switches
- 100 mm shackle
- BS EN12320 Grade 3 and Scandinavian SSFN 014 Grade 2.
- The padlock body is brass and measures 48 mm wide.
- The shackle is 8 mm in diameter made from case-hardened boron steel.

Order Ref.
PL330/100-AB



Locks, Hasps & Accessories: Padlocks



Popular Product

Brass Padlock (ABLOY PL321/20-AB)



Body

Material: Brass
Finish: Chrome

Order Ref.

PL321/20-AB

Shackle

Material: Stainless Steel
Finish: Chrome
Diameter: 5mm
Vertical Clearance: 20mm
Horizontal Clearance: 18mm



Off Shore No1 Choice

Free Engraving

ABLOY PL321/Cable also available (Any-length cable fitted)



Flexible stainless steel shackle. Any length cable can be provided. Ideal to use this cable lockout with your Abloy padlocks under one master key. Call for more information.



Brass Padlock (ABLOY PL321/50-AB Long Shackle)

Body

Material: Brass
Finish: Chrome

Order Ref.

PL321/50-AB







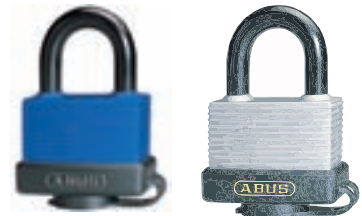

Shackle

Material: Stainless Steel
Finish: Chrome
Diameter: 5mm
Long Shackle Vertical Clearance: 50mm
Horizontal Clearance: 18mm

Fully Insulated Lock

- Solid brass body
- Sealed lock body with cylinder cover to protect cylinder from dirt
- 5-pin cylinder
- Inner components made from non-corrosive materials
- Shock absorbing vinyl casing, protects painted surfaces
- Hardened or stainless steel shackle
- Body and shackle fully insulated against electric shock
- These padlocks are sold in packs of 6
- **Locks are supplied keyed differently, keyed alike upon request**



Order Ref.	Type	Dimensions		
70AL/45 green	Stainless steel shackle (green)			
		53 mm	73 mm	28mm
70AL/45 grey	Hardened steel shackle (grey)			
		53 mm	73 mm	28mm
				
		20.5 mm	24.5 mm	8 mm



Order Ref.
82-ABUS

82 Series Shutter Padlock

Through hardened steel shackle: Rotates when attacked
Solid brass body: Reliable security
Precision pin tumbler cylinder
Rustfree internal components: Durable Security
Hardened steel pin in lock body
Many more keyed alike suites available

Locks, Hasps & Accessories: Padlocks



Steel Padlock (**ABLOY Padlock PL340-AB - Standard Shackle**)

- Extra strong steel padlocks where high security is required and ideal for; construction equipment, trailers, storage bins, roller shutter doors, warehouses trucks and remote storage areas.
- The case hardened steel body is highly resistant to all types of physical attack
- Equipped with hardened boron steel shackle diameter 10 mm and 25 mm high
- The padlock body is manufactured from case-hardened steel and measures 57 mm wide.
- BS EN12320 Grade 4 & Scandinavian SSFN 014 Grade 3

Order Ref.
PL340-AB

Steel Padlock (**ABLOY PL340/50-AB Long Shackle**)

- Extra strong steel padlocks where high security is required and ideal for; construction equipment, trailers, storage bins, roller shutter doors, warehouses trucks and remote storage areas.
- The case hardened steel body is highly resistant to all types of physical attack
- The shackle is manufactured from case-hardened boron steel and is 10 mm in diameter. and 50 mm high
- The padlock body is manufactured from case-hardened steel and measures 57 mm wide.
- BS EN12320 Grade 4 & Scandinavian SSFN 014 Grade 3



Order Ref.
PL340/50-AB

Granit ABUS Plus Close Shackle Padlocks



- 250,000 manufactured key differs:
- Highest protection against manipulation
- Through hardened steel alloy shackle:
- Resists hackshaw attacks
- Hardened steel alloy body:
- Optimum drill and pull resistance
- Re-keyable mechanism:
- Allows additional locks to existing keys
- Many more keyed alike suites available:
- Convenient high security

Dimensions		
65 mm	85 mm	35 mm
18 mm	16 mm	11 mm

Order Ref.
37RK/60

Dimensions		
77 mm	103 mm	37 mm
29 mm	35 mm	14 mm

Order Ref.
37RK/70

Dimensions		
79 mm	94 mm	39 mm
22 mm	22 mm	14 mm

Order Ref.
37RK/80

Steel Padlock (**ABLOY PROTEC PL350/25**)

- Case Hardened steel body provides tough protection for high security applications including; containers, train wagons, trucks, lorries, warehouses.
- PL350-AB is equipped with case hardened boron steel shackle, diameter 14 mm and diameter 72 mm
- 25 mm shackle
- BS EN12320 Grade 5 and Scandinavian SSFN 014 Grade 4.
- The padlock body is manufactured from case-hardened steel and measures 72 mm wide.
- All ABLOY® padlocks come with a 5 year warranty.

Order Ref.
PL350/25-AB



Steel Padlock (**ABLOY Padlock PROTEC PL350/50-AB**)

- Case Hardened steel body provides tough protection for high security applications including; containers, train wagons, trucks, lorries, warehouses.
- PL350-AB is equipped with case hardened boron steel shackle, diameter 14 mm
- 50 mm shackle
- BS EN12320 Grade 5 and Scandinavian SSFN 014 Grade 4.
- The padlock body is manufactured from case-hardened steel and measures 72 mm wide.
- All ABLOY® padlocks come with a 5 year warranty.



Order Ref.

PL350/50-AB



Steel Padlock With Raised Shoulders (**ABLOY Padlock PL342-AB**)

- Extending Case Hardened steel body to surround shackle means it is virtually impregnable against attack by cutting and prying tools.
- Suitable for heavy sliding doors, train wagons, trucks, warehouses etc.
- PL342-AB is equipped with case hardened boron steel shackle, diameter 10 mm
- 25 mm closed shackle
- EN12320 Grade 4 and Scandinavian SSFN 014 Grade 3.
- The padlock body is manufactured from case-hardened steel and measures 57 mm wide.
- All ABLOY® padlocks come with a 5 year warranty.

Order Ref.

PL342-AB



Large Order? Call for Quote!

Brass Padlock (**ABLOY Padlock PL341/25-AB Standard Shackle**)

- A strong padlock for storage doors, gates and windows, trailers and protective bars storage, lockers, boats, rollershutter doors
- Equipped with hardened boron steel shackle, diameter 10 mm.
- High security BRASS padlock with chrome finish 25 mm shackle height.
- The padlock body is manufactured from brass and measures 57 mm wide.
- BS EN12320 Grade 3 & Scandinavian SSFN 014 Grade 2



Order Ref.

PL341/25-AB



Order Ref.

37/55-AB

Granit ABUS Plus Padlocks (37/55 Series)

- 250,000 manufactured key differs: Highest protection against manipulation
- Through hardened steel alloy shackle: Resists hacksaw attacks
- Hardened steel alloy body: Optimum drill and pull resistance
- 11mm shackle: CEN grade 4 security
- Ball bearing locking: Resists lever and torison attacks
- Open shackle: Ideal for use with chain
- Long shackle (HB) versions available: For most security needs
- Re-keyable version available: Allows additional locks to existing keys
- Many more keyed alike suites available: Convenient high security

Brass Padlock (**ABLOY Padlock PL341/50-AB Long Shackle**)

- A strong padlock for storage doors, gates and windows, trailers and protective bars storage, lockers, boats, rollershutter doors
- Equipped with hardened boron steel shackle, diameter 10mm
- High security BRASS padlock with chrome finish 50mm shackle height
- The shackle is manufactured from case-hardened boron steel and is 10 mm in diameter.
- BS EN12320 Grade 3 & Scandinavian SSFN 014 Grade 2
- The padlock body is manufactured from brass and measures 57mm wide

Order Ref.

PL341/50-AB



Locks, Hasps & Accessories: Padlocks

Brass Padlock With Brass Shackle

Full Brass Body & Shackle range are specifically designed as lock-off padlocks with anti-spark shackles.

- Padlock bodies and keys stamped with unique reference number: FREE
- Engraving e.g Company/Resellers Name : FREE
- Padlock & Key Differs recorded for each customer ensuring each padlock is unique on future orders.
- Over 40,000 padlock differs available
- Rustproof brass bodies and shackles.(Steel shackles can be supplied if preferred).
- Padlocks can be made to your specific keying requirements.
- All our brass padlocks are made in Great Britain.

Rust Proof Brass Padlock With Standard Brass Shackle - Made In UK

Brass Padlocks with Standard Brass Shackle



Order Ref.
C125BS-V15-BG



Order Ref.
C250BS-V25-BG



Order Ref.
C150BS-V19-BG

Rust Proof Brass Padlock With Medium Length Brass Shackle - Made In UK



Order Ref.
C125LBSV32-BG



Order Ref.
C150LBS-V38-BG



Order Ref.
C250LBS-V51-BG

Rust Proof Brass Padlock With Long Brass Shackle - Made In UK



Order Ref.
C125LB-V51-BG



Order Ref.
C150LBS-V64-BG



Order Ref.
C250LBS-V80-BG

Locks, Hasps & Accessories: Padlocks

65MB/15C Padlocks

Solid Brass Body: Reliable security
 Brass Shackle
 Shackle Diameter: 3mm
 Shackle Clearance: 12mm
 Body Width: 16mm
 Padlock Body Height: 32mm
 Rustfree Internal Components : Durable security
 Keyed Alike Versions Available















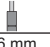

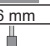

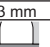
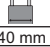
Order Ref.
65MB/15C

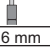
AS2501-ALD Padlocks

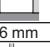
3mm Shackle
 20mm Body
 Keyed to Differ
 Brass Body with a Steel Shackle
 Can be colour coded/painted

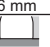
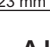
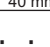
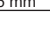

Order Ref.
AS2501-ALD

Order Ref.	Dimensions			Padlocks/ Package
85/40HB63 C				6
	40 mm	102mm	16 mm	
85/20				6
	23 mm	63 mm	6 mm	
				
	21 mm	39 mm	13 mm	
85/40				6
	12 mm	12 mm	3.5 mm	
				
	40 mm	62 mm	16 mm	
85/40HB40				3
	23 mm	22.5 mm	6 mm	
				
	40 mm	79 mm	16 mm	
				
	23 mm	40 mm	6 mm	

Brass Padlock

- Brass body and hardened steel shackle
- All inner components non-corrosive
- Precision pin tumbler cylinder
- **Locks are supplied keyed differently, keyed alike upon request**







Order Ref.
85 Series



145 Series Aluminium Combination Padlocks







Available in blue, brown, green, orange, rainbow colours, red, silver, titanium, violet, yellow.



Dimensions		
		
20 mm	52 mm	14 mm
		
9 mm	22 mm	3 mm







Order Ref.
145/20



Dimensions		
		
30 mm	70 mm	15 mm
		
14 mm	26 mm	5 mm

Order Ref.
145/30









Dimensions		
		
40 mm	81 mm	18 mm
		
21.5mm	27.5mm	6 mm

Order Ref.
145/40

165 Series Combination Padlocks







- Tough solid brass body: Durable Security
- 3 digit (20 % 30mm) resettable combination.
- 4 digit (40mm) resettable combination
- Set your own pin
- Steel Shackle: ideal for luggage sports equipment etc.



Dimensions		
		
20 mm	52 mm	14 mm
		
9 mm	22 mm	3 mm







Order Ref.
165/20



Dimensions		
		
30 mm	70 mm	15 mm
		
14 mm	26 mm	5 mm

Order Ref.
165/30



Dimensions		
		
40 mm	81 mm	18 mm
		
21.5mm	27.5mm	6 mm

Order Ref.
165/40

Locks, Hasps & Accessories: Accessories

Padlock Accessories

Master Lock® offers a large range of padlock accessories that fit with all safety padlocks from Master Lock®.

Long plated steel chain 71CS-ML

- Chains keep padlocks close to equipment requiring safety lockout
- Tags attach to safety lockout padlocks with 71SC8-ML and 71SC9-ML shackle collar
- Engravable brass tag provides individual worker identification (71TAG-ML)



71SC8-ML



71TAG-ML

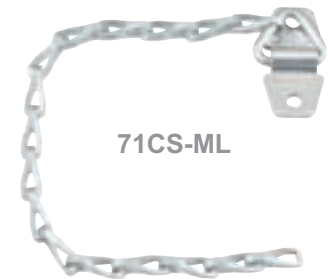

71CS-ML

S100-ML

S100-ML Lockout Lash Lanyard

- Lanyard for mounting padlock near lockout point
- Customize length from 5 to 91 cm.

Order Ref.	Description
71CS-ML	22.9 cm Long lightweight zinc plated steel chain with chain holder attached; fits all Master shackle collars (ordered separately) (12 pk.)
71CH-ML	22.9 cm Long heavy-duty zinc plated steel chain with chain holder attached; fits all Master shackle collars
71SC8-ML	Shackle Collar. Fits 6.35 mm diameter shackles and smaller; for 410-ML, 411-ML, A1105-ML, A1106-ML, A1107-ML, A1165-ML, A1166-ML, A1167-ML, 6835-ML and 6836-ML padlocks
71SC9-ML	Shackle Collar. Fits 7.1 mm diameter shackles; for 3 laminated steel padlocks
71TAG-ML	1.3 x 4.4 mm Brass tag with ring for attaching to shackle collars listed above
S100-ML	Lockout Lash
S125-ML	Padlock Caddy

Padlock Caddy

- Suitable for transportation of lockouts required for lockout
- Ensures user has addressed all lockout points
- Customizable for number of padlocks needed per lockout site
- Supporting item of lockout consulting program



S125-ML

Brass I.D. Tags

- Instant identification of assigned padlock user
- Withstands rugged work environments
- Can be engraved by using engraver or stamp kits
- Max. shackle diameter: 9.5 mm



Order Ref.	Description	Packaging
265378-BR	Brass tags & attachment rings	12
265379-BR	Collars and rivets	12

“Cobra” Cable

Flexible steel wire with protective PVC coating for use with a padlock.



Maximum Chain Security

- Far more secure than steel cables
- Chain made from hardened special chain steel
- Fabric sleeve protects paint work and chrome from damage

1 Cable/Packet	
Order Ref.	Dimensions
805844-BR	Ø8 mm / 250 cm long



1 Cable/Packet	
Order Ref.	Dimensions
805845-BR	Ø 8 mm / 110 cm long
805846-BR	Ø 10 mm / 110 cm long



Shackle Chain

- Why not add Chain to your Padlock allowing you to lockout machines or keep the padlocks secure near lockout equipment for example.
- Various Size Chains Can be Added to All Lockout Tagout Padlock Range Choose Length & then update Quantities at order stage if wanting more than one.

Padlock Identification Labels

- Ideal to write the employee's name, the department/service/team number.
- Labels available with ID picture. Labels available for padlock No 411-ML and 6835-ML.

For standard labels – special for 6835-ML and 3-ML padlocks, order the reference 461-ML.

For ID labels, order the reference

0411-ML - 5705-ML for labels specific for 411-ML padlocks

6835-ML - 5700-ML for labels specific for 6835-ML padlocks.

6835-ML - 5700-ML



461-ML



0411-ML - 5705-ML



- Labels for Zenex™ Padlock No 406-ML and 410-ML are available in 12 languages: French, English, German, Spanish, Italian, Portuguese, Flemish, Czech, Polish, Hungarian, Russian, Chinese, Japanese
- Labels for Zenex™ padlocks No 411-ML are available in bilingual: English/French, English/German, English/Spanish, English/Italian, English/Portuguese, English/Flemish, English/Czech, English/Polish, English/Hungarian, English/Russian, English/Chinese, English/Japanese
- Write-on and erasable labels. Can be written on with a pencil or a marker.

Order Ref.	Description
0411-ML - 5705-ML	Photo ID labels for N° 411 padlocks (6 pk.)
6835-ML - 5700-ML	Photo ID labels for N° 1105-ML, 1106-ML, 1107-ML, 1165-ML, 1166-ML, 1167-ML, and 6835-ML padlocks (6 pk.)
461-ML	Padlock labels with clear overlamine (40 pk)

Zenex™ is a registered trademark of Master Lock®

Locks, Hasps & Accessories: Lockout Hasps

Lockout hasps are integral parts of a successful safety lockout program, providing effective multi-person lockout.



Safety Lockout Hasps

Lockout by Multiple Workers at Each Lockout Point

- Attach hasp to isolation point
- Control cannot be turned on until last worker's padlock is removed from hasp
- Multiple styles available to fit most needs.

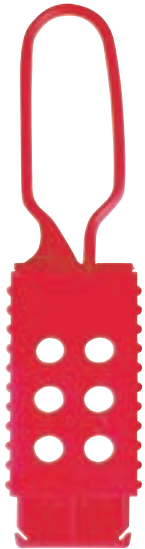
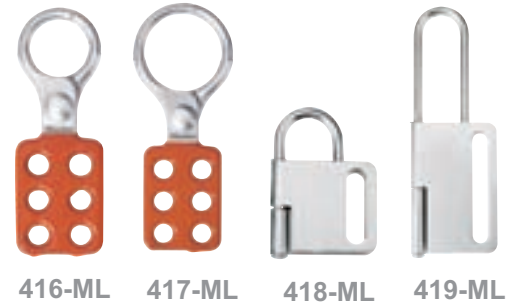

428-ML

Zenex™ Non-conductive hasp Body and Jaw in thermoplastic Zenex™: dielectric protection, non-conductive, anti-sparking. Ideal for electrical applications.



S430-ML



Suitable for isolation points less than 6 mm diameter.

S430-ML - 4 mm Zenex™ hasp

- Plastic Zenex™ body
- Can be locked out with 2 padlocks
- Performs effectively in extreme conditions temperature range. Withstands chemicals. U.V stable.

S431-ML - 4 mm Stainless Steel hasp

- Stainless Steel body
- Can be locked out with 8 padlocks



S431-ML



427-ML

Labeled Snap-on Hasp

- Combines multiple-person lockout and tagout identification
- Anodized aluminum and stainless steel construction for combined corrosion-resistance and strength.

Zenex™ is a registered trademark of Master Lock®.

Order Ref.	Description	inside jaw Ø	Padlock capacity
416-ML	Spark Resistant Aluminum	25 mm	6
417-ML	Spark Resistant Aluminum	38 mm	6
418-ML	Heavy Duty Steel	25 mm	4
419-ML	Heavy Duty Steel	25 mm	8
420-ML	Steel Jaw with Vinyl Coated Handle	25 mm	6
421-ML	Steel Jaw with Vinyl Coated Handle	38 mm	6
427-ML	Labeled Snap-On red Hasp [available in 8 colors]	44 x 54 mm	5
428-ML	Nylon Non-Conductive Hasp	25 x 63 mm	6
429-ML	Dual Jaw Aluminum Hasp	44 x 54 mm	8
ALO80-ML	Tabbed Steel Jaw with Vinyl Coated Handle	25 mm	6
ALO802-ML	Tabbed Steel Jaw with Vinyl Coated Handle	38 mm	5
S430-ML	4 mm hasp	25 mm	2
S431-ML	Stainless Steel Hasp with 4 mm dia. shackle	25 mm	8
701-HO	Steel Jaw with Vinyl Coated Handle	25 mm	6
702-HO	Steel Jaw with Vinyl Coated Handle	38 mm	6

Non-Conductive Lockout Hasp

- Made of strong, rigid red plastic resin
- Offers high flexibility, resistance to cracking and most chemicals
- Has excellent electrical insulating characteristics
- Performs at low temperatures, excellent heat resistance
- Lockout Shackle fits in holes with a diameter of minimum 10 mm
- Max.shackle diameter: 9 mm
- Min.shackle clearance: 20 mm
- Packaging: 1 piece



Order Ref.	Description
045582-BR	Nonconductive Lockout Hasp



Nylon Lockout Hasp

- Non-conductive nylon hasps accommodates up to 6 locks
- Withstands up to 450 kg, yet weighs only 30 g
- Locks out any piece of equipment safely and effectively
- Lockout Shackle fits in holes with a diameter of minimum 7 mm
- Max.shackle diameter: 9 mm
- Min.shackle clearance: 20 mm
- Packaging: 1 piece



Order Ref.	Description
236916-BR	Nylon Lockout Hasp



Safety Lockout

- Allow six workers to lock out a single energy source
- Vinyl coated high tensile steel
- Available in red and yellow
- Available in 2 sizes
- Max.shackle diameter: 9.5 mm
- Min.shackle clearance: 20 mm
- Packaging: 12 pieces



Order Ref.	Shackle width	Colour
805840-BR	25 mm	Red
805841-BR	38 mm	Red
805842-BR	25 mm	Yellow
805843-BR	38 mm	Yellow



SafetyPal
Experts In Safety Solutions

Why not check out our brand new SafetyPal website which provides general safety equipment including P.P.E., first aid and other site maintenance products.

www.safetypal.co.uk
A new division of Lockout Tagout Safety Ltd.



Locks, Hasps & Accessories: Lockout Hasps



Economy Lockout

- Used on fuse or switch boxes
- Sturdy steel
- Hasp: 25.4 mm
- Accepts 6 padlocks
- Max. shackle diameter: 10 mm
- Min. shackle clearance: 20 mm
- Packaging: 1 piece



Order Ref.
236920-BR



Stubby Lockout

- To be used when lockout conditions vary in size
- Two hasp sizes: one is 31.75 x 44.45 mm the other has a 19 mm diameter
- Lockout small switch boxes to large control units and levers with one device
- No need for separate hasps of different sizes
- Accepts 6 padlocks
- Max. shackle diameter: 10 mm
- Min. shackle clearance: 20 mm
- Packaging: 1 piece



Order Ref.
236919-BR



Heavy Duty Steel Lockout

- Tamperproof design prevents vandalism
- Solid U-shape steel bolt cannot be pried apart once locks are in place
- Holds up to 3 locks
- Inside diameter of U-shape bolt 25.4 mm
- Packaging: 1 piece
- Max. shackle diameter: 9 mm
- Min. shackle clearance: 20 mm



Order Ref.	Description
236918-BR	Lockout device
230000-BR	Lockout device + chain (150 mm)

Blank Safety Lockout Hasps

- Material: aluminium
- Packaging: 5 pieces
- Size: 184.1 x 76.2 x 4.7 mm
- Max. shackle diameter: 8 mm
- Min. shackle clearance : 20 mm



Colour	Order Ref.
Red	265399-BR
Blue	225199-BR
Green	225198-BR
Gold	225197-BR
Silver	225196-BR



Labelled Safety Lockout Hasps

- Combination of lockout and tagout
- A single employee can lock out and service equipment
- Up to 5 additional employees can apply their tags and locks
- Tough 5052 anodised aluminium alloy
- Use pens, pencils and permanent markers
- Print from pens and pencils can be erased
- Size: 184.1 x 76.2 x 4.7 mm
- Max. shackle diameter: 8 mm
- Min. shackle clearance : 20 mm



Order Ref.	Text
265390-BR	Do not operate
265393-BR	Ne pas faire fonctionner
265391-BR	Nicht schalten
265392-BR	Niet bedienen



 See page 59 for permanent markers

Customize-it

Combine these blank hasps with customised labels. With or without a logo, with or without a bar code, your own specific text...

Contact Lockout Tagout Ltd for more information.

Lockout Stations

Lockout stations provide a central base location for safety lockout/tagout components.



Virtually Indestructible, the Strongest Stations Available

- Available filled or unfilled. Make your own station and select your padlock: Zenex™, Aluminum or Steel.
- Integrated, one-piece moulded construction eliminates loose parts
- Resilient polycarbonate material provides twice the heat resistance and quadruple the impact strength of typical stations
- Exclusive translucent cover protects contents
 - Lockable to prevent loss of valuable safety lockout padlocks
 - Secure with a combination lock for simple access control
 - Innovative hinge holds cover open for easy product selection
- Safety Hasps and Tags included
- Plus, a free of charge Safety Lockout Padlock Key Charting System is available to you. Simply return the enclosed mail-in card after your purchase Master Lock® will supply a Registered System number, maintain a record of the padlock key cuts provided with your station and ensure that there is no unwanted padlock key cut duplication on your future orders – this is critical for Safety Lockout!



1484BP410-ML



1482B3-ML



1483BP410-ML



Industrial No1 Choice

410RED-ML Xenoy® Padlock	Base & Cover (unfilled)	Description	Dimensions (HxLxW)
1482BP410-ML	1482B-ML	Contains 4 Padlocks; 2 – 420-ML Hasps; 1 pack of 12 x 497A-ML Tags	311 x 406 x 44 mm
1483BP410-ML	1483B-ML	Contains 10 – Padlocks; 2– 420-ML Hasps; 2 packs of 12 x 497A-ML Tags	394 x 559 x 44 mm
1484BP410-ML	1484B-ML	Contains 20 – Padlocks; 4 – 420-ML Hasps; 4 packs of 12 x 497A-ML Tags	559 x 559 x 44 mm



Group Lockout Centres

- 2 loose mounted internal shelves, equally spaced within the key safe.
- The clear window in the door is made from 3mm acrylic, which is designed to permit entry to the safe by breaking, in case of emergency.
- All secondary locks are unique and are supplied complete with a brass tag, engraved with the key safe number and secondary lock identification.

Type 1 Key Safe

- Type 1 Key Safe measures 150mm wide x 200mm high x 105mm deep
- 4 unique secondary locks, marked A, B, C, D and a central control lock.

Type 2 Key Safe

- Type 2 Key Safe measures 150mm wide x 230mm high x 105mm deep
- 7 unique secondary locks, marked A, B, C, D, E, F, G and central control lock

Order Ref.	Description
002710-KW	Type 1 Key Safe
002721-KW	Type 2 Key Safe

Zenex™ is a registered trademark of Master Lock®.

Lockout Storage: Lockout Stations

Deluxe Lockout Stations

Large Capacity Lockout Station Holds Departmental Lockout components

- Available filled or unfilled. Make your own station and select your padlock: Zenex™, Aluminum or Steel.
- Durable construction ensures long life in your facility
- Covered compartments protect devices and keep dust and grime out
- Upper and lower sections lockable to ensure devices are there when needed for lockout. Secure with a combination lock for simple access control
- 16 hanger clips hold 2 padlocks or lockout hasps each
- Moveable dividers in top and bottom trays help organize devices
- Lower half has two tip-out drawers. Each measures 22.5 cm wide x 17.5 cm high x 8.2 cm deep
- Dividers included to create 2, 3, 4, 5 or 6 compartments
- Each compartment holds 25 tags. Total capacity of lower unit 150 tag.
- Measures (H x W x D) : 67.3 cm x 55.9 cm x 10.5 cm.



S1900VE1106-ML

410RED-ML Zenex® Padlocks	Unfilled	Description
S1900VE410-ML	S1900-ML	Contains: 6 – Padlocks; 2 – 420-ML Hasps; 1 – 427-ML Snap-On Hasp; 1 – 8611-ML Adjustable Cable Lockout; 1 – 480-ML, 1 – 481-ML, 1 – 482-ML & 1 – 483-ML Gate Valve Lockouts; 1 – 468L-ML Ball Valve Lockout & 1 - S3068-ML ; 1 – S2005-ML Compact Plug Prong Lockout; 1 – 488-ML Plug Cover; 2 – 491B-ML, 6 – 493B-ML Circuit Breaker Lockouts; 2 pcs – 496B-ML Wall Switch Covers; 2 packs of 12 497A-ML Tags. Space for additional padlocks or lock-out devices as desired.



Large Order? Call for Quote!

Lockout Station

Lockout Station Holds Locks, Hasps and Devices

- Available filled or unfilled. Make your own station and select your padlock: Zenex™, Aluminum or Steel.
- 8 Hanger clips hold 2 padlocks or lockout hasps each
- Top and bottom compartments each have 5 moveable dividers for organising devices
- Durable construction for years of use in corrosive environments
- Cover protects padlocks and devices from dust and grime
- Lockable. Use combination padlock to limit access to authorized employees
- Measures (H x L x W) : 39.4 cm x 55.9 cm x 10.5 cm



S1850E410-ML

410RED-ML Zenex™ Padlock	(unfilled)	Description
S1850P410-ML	S1850-ML	Electrical Lockout Focus. Contains: 6 – Padlocks; 1 – 420-ML Hasp; 1 – 427-ML Snap-On Hasp; 1 – S2005-ML Compact Plug Prong Lockout; 1 – 488-ML Plug Cover; 2 – 491B-ML, 4 – 493B-ML Circuit Breaker Lockouts; 2 – 496B-ML Wall Switch Covers; 2 packs of 12 x 497A-ML Tags.
S1850VA410-ML	S1850-ML	Valve Lockout Focus. Contains: 6 – Padlocks; 1 – 420-ML Hasp; 1 – 427-ML Snap-On Hasp; 1 – 480-ML, 1 – 481-ML & 1 – 482-ML Gate Valve Lockouts; 1 – 468L-ML Ball Valve Lockout & 1- S3068-ML ; 2 packs of 12 x 497A-ML Tags.

Zenex™ is a registered trademark of Master Lock®.

Lockout Storage: Lockout & Tag Stations

Tags Stations

Compact Lockout Station Holds Machine Specific Lockout Devices and Padlocks Near Lockout Point

- Four hanger clips for safety padlocks or hasps
- Durable construction for years of use in harsh environments
- Includes face labels in English, French/English or Spanish/English
- Available filled or unfilled
- Measures 24.8 cm wide x 19.7 cm tall x 8.6 cm deep
- Bin measures 7.5 cm wide x 7.6 cm tall x 7.3 cm deep.



410RED-ML Xenoy® Padlock	(unfilled)	Description
S1705P410-ML	S1700-ML	Contains: 1 – padlock, 1 – 421-ML hasp and 2 packs of 12 tags
S1720E410-ML	S1700-ML	Contains: 2 – padlocks, 4 – tags, 2 – 491B-ML and 2 – 493B-ML circuit breaker lockouts
S1745E410-ML	S1700-ML	Contains: 1 – padlock, 1 – 488-ML electrical plug lockout, and 1 pack of 12 tags

Custom/Departmental Lockout Stations

As the safety needs of each worker within a company can vary, Lockout Tagout Safety Ltd, provide a custom lockout kit option. This allows personalised lockout station control centres to be created containing only the useful aspects of an 'off-the-shelf' kit specific to your workplace. A variety of padlocks, tags, hasps and other specialised safety equipment may be included in these stations and a shadow effect allows easy visibility of when equipment is missing.

For more information on how to build your own custom lockout station please call 01642 244017 or email us at info@lockout-tagout.co.uk and let us know which equipment you require. If you are unsure as to which equipment you may need to comply with safety legislation, we can arrange on-site visits to give you some advice.



Power Plant No1 Choice

In this example, a reminder of the 9 basic steps of Lockout Tagout is displayed.

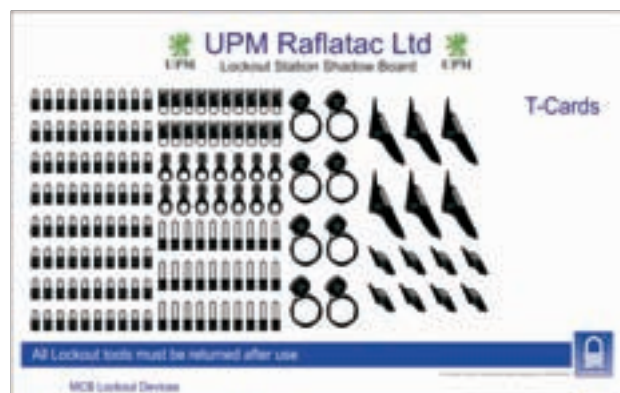
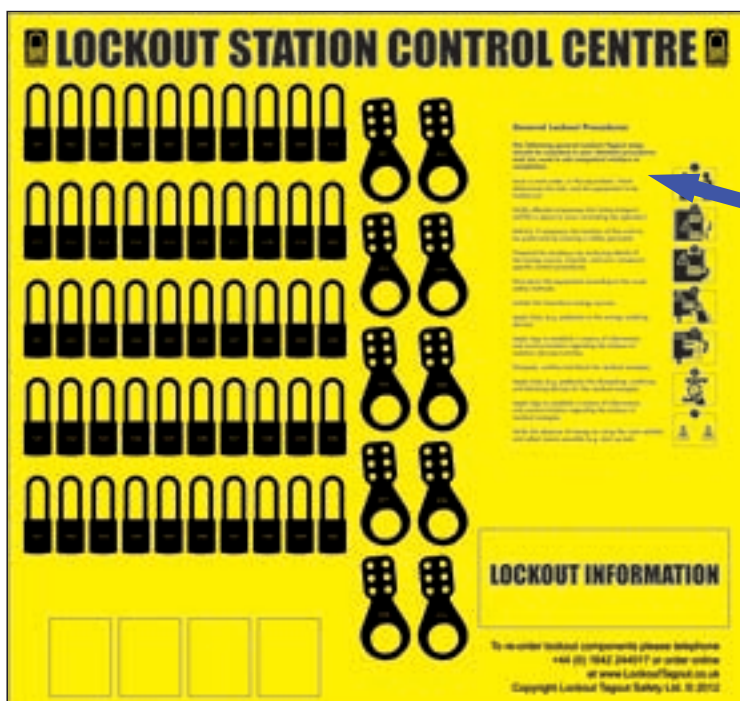

Lockout Storage: Lock Boards

Lock Boards

Brady®'s high visibility lock boards make your locks, tags and lockouts easy to find and use. Built for the toughest conditions, these lock boards are made of durable plastic material.

The lock boards are available as boards only. No components are included.

10-Lock Board

- Dimensions: 34.2 x 34.2 cm



Shipping No1 Choice



Order Ref.	Description
050990-BR	10 Capacity Lock Board (board only)
050990F-BR	10 Capacity Lock Board (board only)

20-Lock Board

- Dimensions: 59.7 x 29.2 cm

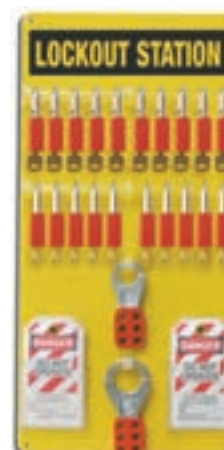

Order Ref.	Description
050991-BR	20 Capacity Lock Board (board only)
050991F-BR	20 Capacity Lock Board (board only)

5-Lock Board

- Dimensions: 29.2 x 39.3 cm



Order Ref.	Description
050989-BR	5 Capacity Lock Board (board only)
050989F-BR	5 Capacity Lock Board (board only)

36-Lock Board

- Dimensions: 54.6 x 59.7 cm



Power Plant No1 Choice

Order Ref.	Description
050992-BR	36 Capacity Lock Board (board only)
050992F-BR	36 Capacity Lock Board (board only)

Industrial Strength Lockout Stations



- Lockable all metal, yellow powder coated cabinet
- One adjustable shelf (extra shelves available)
- Lockout Safety tips on inside of door
- Can hold a wide variety of lockout devices
- Can be wall mounted or easily transported
- Dimensions (H xW x D): 406.4 x 355.6 x 152.4 mm

Order Ref.	Description
800123-BR	Industrial Strength Lockout Station
800129-BR	Extra Shelf

Heavy Duty Padlock Station

- Heavy gauge steel with durable powder coat finish ensures long life
- Wall-mounted
- Includes labels in English, Spanish/English, and French/English.

Order Ref.	Dimensions	Description
S1506-ML	159 mm wide x 76 mm tall x 38 mm deep.	Holds 6-8 padlocks
S1518-ML	405 mm wide x 76 mm tall x 38 mm deep.	Holds 18-22 padlocks



S1506-ML



800120-BR



S1518-ML

Padlock Station

- Steel padlock holder with red plastic coating
- Small holder allows up to 6 padlocks
- Large holder allows up to 36 padlocks
- Padlocks not included
- Packaging: 1 piece

Order Ref.	Description
800120-BR	Small Padlock Station
800121-BR	Large Padlock Station

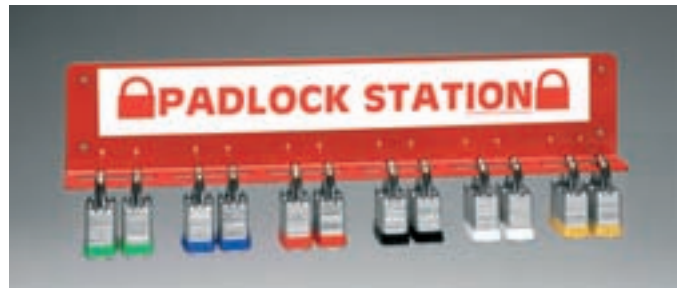

Group Lock Box

- Simplifies lockout of large equipment
- After machine or process is locked out, the key or keys of the machine are placed in a lock box. Each authorised work team member places a personal lock or tagout device in the group lock box.
- Ensures that no single employee has access to the box unless ALL employees have removed their locks or tags
- Packaging: 1 piece



Order Ref.	Color	Dimensions
065699-BR	Red	230 x 88 x 150 mm
045190-BR	Blue	230 x 88 x 150 mm
065672-BR	Yellow	230 x 88 x 150 mm



Key Group Lockout Box - Full Range on page 50



Lockout Storage: Lock Boxes & Padlock Centres



Latch Tight™ Group Lock Boxes

Storage Devices Capture keys for effective lockout of large equipment

- Secure each lockout point on a piece of equipment with a single padlock
Place the keys in the group lock box and then each authorized employee places their personal padlock on the lock box
- When work is complete, employees take their personal padlocks off the lock box, freeing the keys inside. Keys inside can not be accessed until the last employee removes their padlock
- All Master Lock group boxes feature an exclusive, Latch Tight™ locking mechanism that prevents keys from being accessed until the last padlock or lockout hasp is removed from the box. Provides the highest level of security available in a group lock box
- Durable powder coated finish with stainless steel handle
- 503RED-ML and 503YLW-ML can be mounted to wall or carried from job to job
Available in red or yellow. Accepts 14 padlocks or lockout hasps
- 498A-ML is a portable solution. Available in red. Accepts 12 padlocks or lockout hasps.

Order Ref.	Description	Dimensions
503RED-ML	Dual Application Group Lock Box - Red	324 x 89 x 162 mm
503YLW-ML	Dual Application Group Lock Box - Yellow	324 x 89 x 162 mm
498A-ML	Portable Group Lock Box	152 x 235 x 95 mm



498A-ML



503RED-ML



503YLW-ML



Group Lockout Centre

- 18 hooks for keys and 2 slots for locks (not included)
- Apply a padlock to the key box to lock out multiple sources of energy controlled by the padlock keys inside the box
- Made of acrylic
- Not designed to prevent forced entry.
- Packaging: 1 piece

Order Ref.	Description	Dimensions (H x W x D)
800127-BR	Lockout Centre 18 hooks	19.5 x 40.6 x 6.4 cm
800116-BR	Lockout Centre 8 hooks	19.5 x 30.5 x 6.4 cm
800117-BR	Lockout Centre 3 hooks	15 x 15 x 8 cm

Padlock Control Centre

- Red powder coated steel
- Each nickel coated metal hook is large enough to hold two locks (not included)
- Two keys provided for cabinet lock.
- Packaging: 1 piece

Order Ref.	Description	Dimensions(H x W x D)
800118-BR	Centre - 18 hooks	39.4 x 45.7 x 5 cm
800119-BR	Centre - 8 hooks	25.4 x 30.5 x 5 cm





Large Lockout Pouch

- Made of nylon with attachment loop on back
- Create your own custom lockout kit and use the pouch to store it neatly
- Dimensions (H xW x D): 20.3 x 17.8 x 7.6 cm
- Packaging: 1 piece

Order Ref.	Description
050979-BR	Large Lockout Pouch



Lockout Belt Pouch

- Made of heavy duty nylon with loops for hanging on a belt
- Simply fill the pouch with the lockout devices you need and have them handy when they are required.
- Dimensions (H xW x D): 12 x 19 x 5 cm
- Packaging: 1 piece

Order Ref.	Description
051172-BR	Lockout Belt Pouch



Lockout Satchel

- Made of 1000 denier red cordura nylon with a 95 cm shoulder strap.
- Includes latchable front pocket and two side mesh holders.
- Dimensions (H xW x D): 35.5 x 10 x 38 cm
- Packaging: 1 piece

Order Ref.	Description
806200-BR	Lockout Satchel



Lockout Duffel Bag

- Made of 600 denier polyester with a 95 cm removable shoulder strap and 8 inside pockets
- Dimensions (H xW x D): 12.5 x 42 x 21,5 cm
- Packaging: 1 piece

Order Ref.	Description
099162-BR	Lockout Duffel Bag

Key Control Systems: Economy & Lock Options



Economy Range

Ideal for low security key management. Excellent value for money key cabinet.

Order Ref.	Description
3100-ST	20 hooks (200 x 155 x 60mm)
3101-ST	24 hooks (240 x 190 x 60mm)
3102-ST	42 hooks (300 x 210 x 60mm)
3103-ST	60 hooks (365 x 320 x 55mm)
3104-ST	80 hooks (525 x 320 x 55mm)
3105-ST	100 hooks (525 x 320 x 55mm)
3106-ST	120 hooks (685 x 320 x 55mm)
3107-ST	150 hooks (685 x 320 x 55mm)
3108-ST	300 hooks (685 x 360 x 110mm)



Steel Wall Mounted or Portable Key Group Lockout Box

The steel group lockout tagout boxes shown here are in stock and available for immediate delivery or shipout to areas anywhere in the world. Don't see the lockout box that you need? We can customize or design a prototype to your specifications.

Case and hooks are constructed of steel for long-lasting durability.

Optional carrying handles are available for most logout tagout box models and allow for either portable or stationary use.

Mounting holes allow mounting the lockout box to a wall or equipment.

Spring loaded retainer bar holds keys in place while carrying and prevents key removal by shaking in inverted position.

Clear acrylic window provides good visibility of keys and tags.

Interior chart holder is provided on most lockout box models for your company's lockout/tagout forms.

Durable red powder paint is used on the lockout box and handle. Key holders are painted white.



Order Ref.	Description	Dimensions (WxHxD)
Model GL-1/2	Lockout box 4 hook	300mm x 275mm x 75mm
Model GL-1	Lockout box 8 hook	315mm x 440mm x 75mm
Model GL-2	Lockout box 24 hook	450mm x 500mm x 75mm
Model GL-3	Lockout box 50 hook	150mm x 240mm x 75mm



A range of cabinets to control and track keys. Effective key management and secure storage is an essential part of any organisation's security strategy. Our range of key control systems, the most comprehensive available, is manufactured and tested to the highest standards, making them ideal for safeguarding against lost or stolen keys even within high security commercial applications.

Alternative Locking Options

Unless stated the cabinet will be supplied with key locking as standard. The type of lock will depend upon its position within the range. Securiskey recognise that there may be a requirement to add or alter the standard locking configuration. It is for this reason we offer the following alternatives.

A ELECTRONIC LOCK WITH AUDIT TRAIL
Full function lock with multiple user codes, audit trail and time locking to prevent unauthorised entry during specific time zones.



B DIAL COMBINATION LOCK
A combination lock used extensively in the safe industry. Offers in excess of 1 million combinations.



C ELECTRONIC LOCK
A heavy duty lock with versions available from Revo and La Gard depending upon personal preference. All with multiple user codes.



D PADLOCKING CAM LOCK
Designed to replace the standard Cam Lock, this option accepts a padlock with 8mm diameter shackle (max).



E MECHANICAL LOCK
A push button lock similar to those used extensively throughout offices in the UK. This lock type is available in both deadbolt and slam lock option.

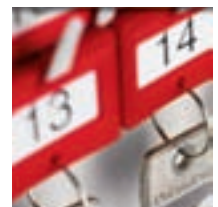

F DIGITAL LOCK
The digital lock has a simple 10 button keypad and a # button which is used when programming. IP54 rated.

Images shown may not be indicative of the lock fitted

High Security Key Filing Systems

The ultimate tracking system.

Whether you need a simple key cabinet, a mechanised key control system or a sophisticated key issue and tracking system, our range of high quality storage cabinets help to maintain total accountability of large quantities of keys and help prevent unauthorised access within domestic, commercial and light industrial environments.

With a body constructed from 3 mm steel, as used in the manufacture of cash safes and a 6 mm steel slab door, the High Security cabinets provide unparalleled protection and are used extensively throughout the UK's prestige motor dealers, police stations and banks.

As standard the cabinets are secured with a three-way locking mechanism, shooting 20 mm bolts and using a VdS approved lock, although you have the option of fitting an electronic locking system. They also include adjustable hook bars, clever key tags as with the System cabinets and Vaults. The High Security cabinets are also available in a deeper model for the storage of bunches of keys.

Floor Standing Systems are larger capacity key cabinets and their key panels are on telescopic slides for easy access and storage.



System 100/HS-SK



High Security 960

High Security Systems

Order Ref.	Holds up to	Height	Dimensions			Weight (kg)
			Width	Depth		
System 60/HS-SK	60 keys	ext 436	460	120	25	
System 100/HS-SK	100 keys	ext 636	460	120	35	
System 150/HS-SK	150 keys	ext 636	460	200	43	
System 200/HS-SK	200 keys	ext 636	460	200	46	
System 300/HS-SK	300 keys	ext 636	460	300	53	

High Security Deep Systems

Order Ref.	Holds up to	Height	Dimensions			Weight (kg)
			Width	Depth		
System 50/HS Deep-SK	50 bunches	ext 635	455	180	38	
System 100/HS Deep-SK	100 bunches	ext 1100	455	180	62	

Floor Standing Systems

Order Ref.	Holds up to	Height	Dimensions			Weight (kg)
			Width	Depth		
System FR 960-SK	960 keys	ext 1000	650	560	300	
System FR 1280-SK	1280 keys	ext 1000	650	560	300	
System FR 1560-SK	1560 keys	ext 1200	650	560	310	
System FR 2080-SK	2080 keys	ext 1500	800	560	320	



Door Slab and 20mm Locking Bolts



Optional Hook Bars Double Spaced for Bunches and Car Remotes



Large Order? Call for Quote!

Locking Options - See Page 50: **A B C**

Key Control Systems: Key Vault

Key Vault

Advanced key management.



Large Order? Call for Quote!

Designed to meet the requirements of insurance companies in the control, tracking and security of keys associated with risk to valuables or property, our range of Key Vaults offer twice as much security and strength provided by standard key cabinets. Constructed from 2.5 mm fabricated steel with a 3 mm flush closing door which includes removable hinge pins for easy upgrading, they are ideal for commercial use. These cabinets are also supplied as standard with a half euro profile cylinder that can be upgraded to integrate with an existing master key or security system. As with the System cabinets, the Key Vault has adjustable hook bars, a removable control index, sign-out tabs (to record a paper trail of key usage) and is also available in a deeper model for the storage of bunches of keys.



Key Vault 100-SK



Sign Out Tab



Euro Profile Keylock

Key Vault

Order Ref.	Holds up to	ext	Dimensions			Weight (kg)
			Height	Width	Depth	
Key Vault 30-SK	30 keys	ext	305	230	70	6
Key Vault 48-SK	48 keys	ext	355	300	80	8
Key Vault 100-SK	100 keys	ext	550	380	80	13
Key Vault 200-SK	200 keys	ext	550	380	140	20
Key Vault 400-SK	400 keys	ext	550	730	140	34
Key Vault 600-SK	600 keys	ext	550	730	205	43

Deep Key Vault

Order Ref.	Holds up to	ext	Dimensions			Weight (kg)
			Height	Width	Depth	
Key Vault 48 Deep-SK	48 bunches	ext	355	300	140	8
Key Vault 100 Deep-SK	100 bunches	ext	550	380	140	14
Key Vault 200 Deep-SK	200 bunches	ext	550	730	140	30

Locking Options- See Page 50: **A B C E**

System Cabinets

Affordable key control.

Constructed from 1.5 mm pressed and folded steel and secured with a choice of five locking options, the cabinets provide the space to store and track up to 600 keys and include adjustable hook bars to accommodate different key lengths. Each model is finished in a robust powder coat paint finish (RAL 7035) and has a removable control index for out-of-hours peace of mind, colour-coded hook bars and tags to ensure quick identification, both of which are numbered.

For larger requirements, our range of deep system cabinets provide the extra space required to accommodate bunches or a mixture of bunches and individual keys and are available with 48, 100 or 200 hanging hooks.

These cabinets are best suited to domestic and commercial use for key control and tracking.

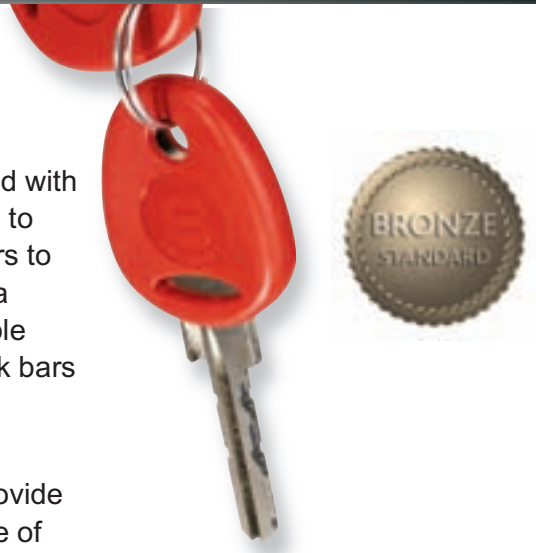

System Cabinets

Order Ref.	Holds up to	ext	Dimensions			Weight (kg)
			Height	Width	Depth	
System 20-SK*	20 keys	ext	260	185	80	2
System 30-SK	30 keys	ext	305	215	80	3
System 35-SK	35 keys	ext	320	245	80	3
System 48-SK	48 keys	ext	355	300	80	4
System 64-SK	64 keys	ext	450	300	80	5
System 100-SK	100 keys	ext	550	380	80	8
System 150-SK	150 keys	ext	550	380	140	13
System 200-SK	200 keys	ext	550	380	140	14
System 250-SK	250 keys	ext	550	380	205	17
System 300-SK	300 keys	ext	550	380	205	18
System 400-SK	400 keys	ext	550	730	140	23
System 500-SK	500 keys	ext	550	730	205	32
System 600-SK	600 keys	ext	550	730	205	34

Deep Systems

Order Ref.	Holds up to	ext	Dimensions			Weight (kg)
			Height	Width	Depth	
System 35/D-SK	35 bunches	ext	320	245	100	3
System 48/D-SK	48 bunches	ext	355	300	120	5
System 100/D-SK	100 bunches	ext	550	380	140	8
System 150/D-SK	150 bunches	ext	550	380	205	14
System 200/D-SK	200 bunches	ext	550	730	140	18



System 100-SK

*No control index

Locking Options - See Page 50: **A B C D F**



Large Order? Call for Quote!

Key Control Systems: Security Systems

Security Systems

PADLOCK SECURITY SYSTEMS: Specially designed to house padlocks and keys used to isolate switchgear or machinery, this system is available in three sizes, providing ample space for up to 100 keys. As standard, the system is fitted with extra deep hooks, staggered and spaced 60mm apart, and includes a Securikey cam lock although alternative mechanisms are available.

Locking Options - See Page 50: A B C D F



KEY VIEW SYSTEMS: As well as all of the features and benefits associated with our system key cabinets, Key View also has a plexi-glass front allowing users a clear visual check of all stored keys without the need for unlocking the door. The system is available in three sizes, with space for between 24 and 50 sets of keys.

Locking Options - See Page 50: D F



System 50 G-SK



Off Shore No1 Choice

EMERGENCY KEY HOLDING BOXES: Of steel construction with a 2mm breakglass front, Securikey's Emergency Key Boxes are designed to hold a restricted key near to a locked door in case of emergencies. Locking options are cylinder lock, padlocking cam lock. The Model KO comes with a security seal and a chained hammer.

Padlock Security Systems

Order Ref.	Holds up to	Height	Dimensions			Weight (kg)
			Width	Depth		
System 24/PL-SK*	24 keys	ext 355	300	120	5	
System 50/PL-SK*	50 keys	ext 550	380	140	10	
System 100/PL-SK*	100 keys	ext 550	730	140	17	

Key View Systems

Order Ref.	Holds up to	Height	Dimensions			Weight (kg)
			Width	Depth		
System 24/G-SK	24 keys	ext 355	300	80	4	
System 32/G-SK	32 keys	ext 450	300	80	5	
System 50/G-SK	50 keys	ext 550	380	80	6	

Portable Systems

Order Ref.	Holds up to	Height	Dimensions			Weight (kg)
			Width	Depth		
System 20/H-SK**	20 keys	ext 260	185	80	2	
System 30/H-SK	30 keys	ext 305	215	80	3	
System 35/H-SK	35 keys	ext 320	245	80	3	
System 63/H-SK	63 keys	ext 320	245	100	5	



Portable Systems

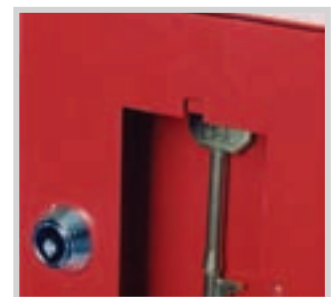

K1 Emergency Key Holding Box

Emergency Key Holding Boxes

Order Ref.		Dimensions(mm)		
		Height	Width	Depth
K1-SK***	ext	153	123	40
K1 Solid Front-SK***	ext	153	123	40
K0-SK****	ext	153	123	40

*Padlocks not supplied **No control index

***Fitted with cylinder lock

****Has no lock, but provision for a seal. Supplied with a hammer and chain plus 2 seals

Key Control Systems: Key Reels

Security at your fingertips

From drivers to porters, security guards to shopkeepers, our self-retracting key reels are a convenient and secure way for keeping keys, tools and ID badges to hand at all times. Lightweight and durable, the key reel can fasten to either belts or clothing and is available in a range of 'own-branded' models to suit individual company requirements – each precision-made and fitted dependent on model with a nylon cord (max 1200 mm) or 600 mm stainless chain.



Krabiner Cord-SK



Midi-Bak



Super 48-SK



Mini-Bak ID

 Large Order? Call for Quote!

Key Bak

Order Ref.	Description
Super 48-SK	Super Deluxe strong model. Can be transformed from spring to belt loop. Commercial 1200mm tough nylon coated Kevlar cord. Polycarbonate case with ball-socket weight support - ideal for heavy key bunches/small tools, etc.
Super 48 Belt Loop-SK	Leather belt loop (2 7/8") version of standard Super 48
Heavy Duty-SK	1200mm Kevlarcord with belt, clip or spinner fixing
Original-SK	600mm stainless steel chain with belt, clip or spinner fixing
Bracket Mounted-SK	For permanent fixing to most surfaces with 600mm stainless steel chain

Securit

Order Ref.	Description
Karabiner – Chain-SK	600mm stainless steel chain with clip fixing
Karabiner – Cord-SK	1200mm Kevlar cord with clip fixing

Midi Bak

Order Ref.	Description
Standard split ring-SK	900mm Kevlar cord with clip and spinner fixing

Mini Bak

Order Ref.	Description
Standard split ring-SK	600mm nylon cord with clip or pin fixing (twin pack)
I.D card holder-SK	600mm nylon cord with clip or pin fixing (twin pack)



Heavy Duty with Belt Loop



Original Clip Fix

Accessories

Order Ref.	Description
Key release-SK	Enables user to quickly detach/return keys from and to the main bunch. Ideal for car keys, torches and small tools.
Hus-key-SK	The Huskey bracket snaps on to your key reel enabling 5 times the normal weight to be carried (For use with Standard & Heavy Duty Models)
Pocket key chain with trigger snap-SK	
Karabiner with split ring-SK	

Own brand on all Mini Bak products (minimum 150 pieces)

All products are clam packed for retail display

Cable Seals: Cable Lock and Breakaway Seals

Cable Lock Seals

Cable seals are available in packs of 100, 500 or 2000. There are three different available lengths (18cm, 60cm and 100cm) although custom lengths may be requested. Several colour options - Red, Gold, Self-Colour, Green and Blue. The cable lock is anodised in solid colours, which accommodate customised laser marking. Anodising also makes colour coding possible and eases identification from a distance.

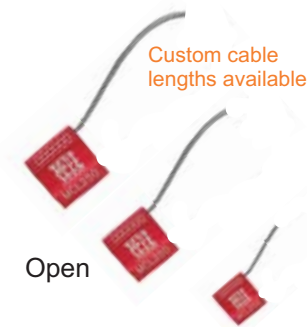

Ideal for long term uses, each cable seal is self locking so once the cable passes through the body the only way to remove it is by cutting. Cable Locks are widely used on Trucks, tanker trucks, air cargo containers, shipping containers, rail cars, calibrators and valves. The one-way locking mechanism provides fast and easy sealing. One end of the cable is permanently secured into the locking body.

All seals are individually numbered to prevent tampering and allow easy identification. All cable locks are etched with permanent laser marking for name, logo, sequential numbers & barcode. Laser marking offers the highest level of security as it cannot be removed or replaced. Parts of the exterior have been designed with a rib pattern, which protects the markings during rough handling.



Order Ref.	Description
2.5MinCabSeal-MF	2.5 mm Mini Cable Lock Seal
3.0MidCabSeal-MF	3.0 mm Midi Cable Lock Seal
3.5MidCabSeal-MF	3.5 mm Midi Cable Lock Seal
5.0MaxCabSeal-MF	5.0 mm Maxi Cable Lock Seal



Don't forget to specify the colour, length and number of cable lock seals you require from the options below:

1. Colour	2. Length	3. Number
Red	18 cm	100
Gold	60 cm	500
Self Colour	100 cm	2000
Green		
Blue		



Cable Breakaway Seals

Features -

1. The cable breakaway seals are etched with permanent laser marking. Laser making offers the highest level of security as it cannot be removed or replaced.
2. The exterior has been designed with a rib pattern, which protects the marking during rough handling.
3. The cable breakaway seals are highly suited to securing valuables for longer periods of time because of its simple yet very efficient locking.
4. One end of the cable is permanently secured into the locking body.
5. The cable breakaway seals are all anodised in solid colours which accommodate customised laser making. Anodising also makes colour coding possible and eases identification from a distance.

Information -

Box Quantity- 100, 250, 500 or 2000 pieces

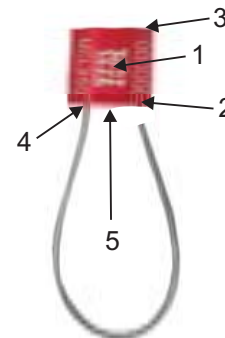

Order Ref.	Description
CABLEBREAKAWAY1.5	1.5mm Breakaway Seal
CABLEBREAKAWAY2.5	2.5mm Breakaway Seal
CABLEBREAKAWAY5.0	5.0mm Breakaway Seal

DOMINOSP-MF Indicative Seal

Colour coding is enabled through different coloured caps and base of seals.
Domino SP seals are etched with permanent laser marking for name, logo, sequential numbers & barcode. Laser marking offers the highest level of security as it cannot be removed or replaced.
Heat staking is deployed to permanently bond caps and sealing.
Alignment holes ensure easy inspection of proper sealing.
The strong and durable metal strap can withstand harsh handling and the climatic elements in a long-haul shipment.
Quantities: 1000, 5000, 25000



Order Ref.
DOMINOSP-MF

DRAGONWP-MF Indicative Seal

The Dragon Seal WP is etched with permanent laser marking for name, logo, sequential numbers & barcode. Laser marking offers high security because it cannot be removed or replaced.
Ultrasonic welding technology is used to fasten caps to the seals. Ultrasonic welding cannot be cut or forced open without leaving clear evidence of tampering.
Metal clip locking provides better locking and greater pull strength to the long, thick strap.
The ribbed pattern on the seal cap and locking body is an extra security feature that provides clear evidence if the seal has been cut or tampered with.
Quantities: 1000, 5000, 10000



Order Ref.
DRAGONWP-MF

FORTCBS-MF Indicative Seal

The Fort-CBS is a strong and durable indicative seal that has been designed for high value cash-in-transit applications / transportations.
Material: Steel Locking and Polypropylene
Total Length: 20" (51cm)
Locking Length: 15" (38cm)
Diameter: 8mm
Pull Strength: 45kg
Application: Bags, sacks and tank trailers
Quantity 1000, 5000 and 10000



Order Ref.
FORTCBS-MF

KLICKER-MF Bolt Lock

Material: Solid steel fully moulded with ABS
Locking Length- 5.1cm
Total Length: 9.3cm
Diameter: 1.1cm
Pull Strength: 1300kg
Application: Anti-Spin bolt seal for containers and trailers
ISO FDIS 17712 Compliant
Colour: Green, Blue, Yellow, Red or White
Box Quantity: 250, 500 or 1000 units
Ideal For Following Applications:-
Shipping Containers
Cargo containers
Trucks, Trailers, Vehicle Door
Rail Freight
Hatch



Order Ref.
KLICKER-MF

Container Bolt Lock

Material: Solid steel with optional ABS molding
Locking Length: 2 inch / 5.2cm
Total length: 3 inch / 8.5cm
Diameter: 8mm
Pull Strength: 1210kg
Application: Economical bolt seal for containers and trailers
Colour: Blue
Box Quantity: 250, 500 or 1000 units



Order Ref.
ContainerBoltLock-MF

Large Order? Call for Quote!

Tagout: Tags & Labels

Warning Tags

Indicate who is responsible for placing a Lockout device and who is authorised to remove it or make changes to it. The tags are manufactured from a flexible polyester, resistant to water, oil and extreme temperatures. Their matt surface allows you to write on them easily with a ballpoint or felt tip pen.

- Packaging: 10 tags with 10 cable-ties
- Sizes: **A:** 75 x 160 mm **B:** 50 x 110 mm

 Large Order? Call for Quote!

Rapid Delivery



Order Ref. A	262950-BR	262951-BR	262952-BR	262953-BR	262954-BR	262957-BR	265549-BR
Order Ref. B	225400-BR	225401-BR	225402-BR	225403-BR	225404-BR	225405-BR	225406-BR

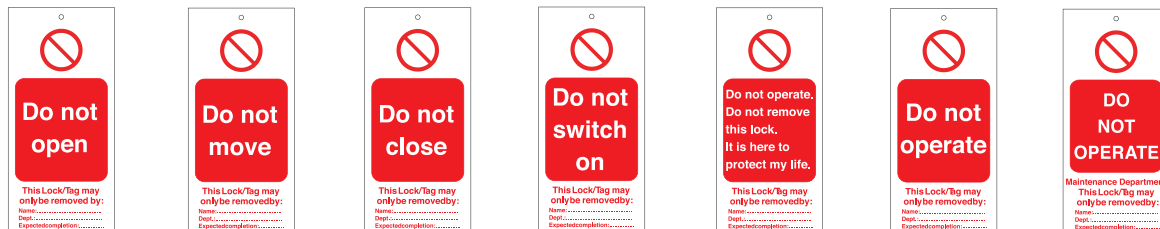

Order Ref. A	265550-BR	262962-BR	262964-BR	262965-BR	256564-BR	265548-BR	256565-BR
Order Ref. B	225408-BR	225409-BR	225410-BR	225411-BR	225412-BR	225407-BR	225413-BR

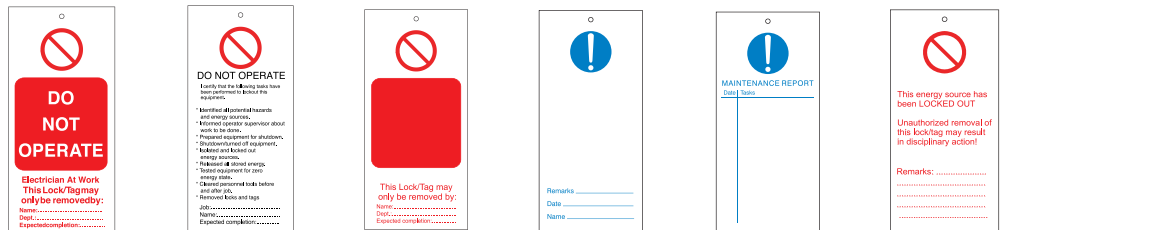

Order Ref. A	256566-BR	256567-BR	256571-BR	225417-BR	225419-BR	Reverse
Order Ref. B	225414-BR	225415-BR	225416-BR	225418-BR	225420-BR	



Order Ref. A	256572-BR	256573-BR	256575-BR	256576-BR	256577-BR
Order Ref. B	225421-BR	225422-BR	225423-BR	225424-BR	225425-BR



Order Ref. A	256578-BR	256579-BR	Reverse
Order Ref. B	225426-BR	225427-BR	



Order Ref.	Description
087052-BR	Permanent marker



TAGOUT

Warning Tags: Machine Related Risks



- Back: blank
- Packaging: 10 tags
- Size: 75 x 160 mm
- Material: semi rigid polyester
- Language: English

Order Ref. 230778-BR 230779-BR 230780-BR 230781-BR

Self-Adhesive Labels: Machine Safety

- Packaging: 1 label
- Size: 100 x 150 mm
- Material: laminated polyester



Order Ref. 230782-BR 230783-BR 230784-BR 230785-BR

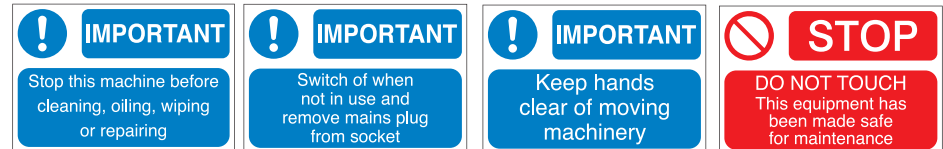

Order Ref. 230786-BR 230787-BR 230788-BR 230789-BR

Brady® Safety Tags

- Brady® Safety Tags provide on-the-spot identification of safety measures
- Very easy applications: can be attached in just seconds
- Tags have ties attached and can be applied to just about any part of any machine. There is no need for extra ties!
- The tag is printed on both sides, making sure the vital information is always visible

Packaging: 10 tags
Material: PVC 0.2 mm

Size:
Tag: 145 x 85 mm
Attachment tie: 15 x 140 mm

Type	Order Ref.	Type	Order Ref.	Type	Order Ref.	Type	Order Ref.	Type	Order Ref.
Danger	241700-BR	Caution, out of order	241701-BR	Caution, men working...	241703-BR	Danger, electric shock risk	241708-BR	Danger, live wire	241710-BR
Danger, contains asbestos	241712-BR	Caution, biohazard	241713-BR	Danger, radioactive material	241714-BR	Do not use out of order	241716-BR	Do not switch on	241717-BR
DANGER Contains asbestos		CAUTION Biohazard		DANGER Radioactive material		Do not use out of order		Do not switch on	
Do not switch on under...	241718-BR	Do not touch	241719-BR	Failed electrical safety test	241720-BR	Tested for electrical safety	241721-BR		
Do not switch on under maintenance		Do not touch		FAILED ELECTRICAL SAFETY TEST		TESTED FOR ELECTRICAL SAFETY			
								Reverse	

Tagout: ID Tags, Holders & Stations

DO NOT OPERATE ID Tags

Heavy Duty Tags Comply with OSHA Lockout/Tagout Standard

- Durable polyester laminate resists water, grease and extreme temperatures
- Heavy duty construction withstands over 22.7 kg. of pull force (meets OSHA requirement); prevents accidental removal
- Customize with name, department, expected completion time
- 11 mm dia. brass grommet accepts all safety padlocks
- Tags available in other languages; call for details
- Single language and bilingual tag options
- A available in French, English, German, Spanish, Italian, Portuguese, Czech, Dutch, Polish, Japanese, Russian (on request).



497A-ML

497ABLC-ML



497AX-ML

Order Ref.	Description	Dimensions (HxL)
497A-ML	English, 1 bag of 12 tags with ties	14.6 cm x 7.9 cm
497AX-ML	Spanish/English 1 bag of 12 tags with ties	14.6 cm x 7.9 cm
497ABLC-ML	French/English 1 bag of 12 tags with ties	14.6 cm x 7.9 cm

Tag Holder

- Compact
- Holds 50 tags, ties and marker pen (not included)
- Clear plastic
- Comes with adhesive strips and screws for mounting in a variety of ways



Order Ref.

800125-BR (station only)

Safety Tag Station

- Organises tags in a central location
- Accommodates 14.6 x 7.6 cm tags

Material: rugged polycarbonated plastic construction

Order Ref.

081773-BR (station only)

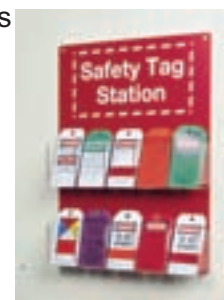

TAGOUT

Compact Tag Stations

Durable Tag Station Holds 18 Tags

- Three hanger clips for safety padlocks or hasps
- Includes face labels in English, Spanish/English and French/English



Large Order? Call for Quote!



S1601AX-ML

Order Ref.	Description	Dimensions (HxL)
S1601-ML	Tag Station (unfilled)	19,7 cm x 14,6 cm x 3,8 cm
S1601A-ML	Tag Station with 12 English Tags	9,7 cm x 14,6 cm x 3,8 cm
S1601AX-ML	Tag Station with 12 Spanish/English Tags	9,7 cm x 14,6 cm x 3,8 cm
S1601FRC-ML	Tag Station with 12 French/English Tags	9,7 cm x 14,6 cm x 3,8 cm

S1800-ML



Deluxe Tag/Lockout Center Holds Multiple Groups of Tags

Order Ref.	Description	Dimensions (HxL)
S1800-ML	Tag Center (unfilled)	279 mm x 559 mm x 105 cm

Tags sold separately

Tagout: Safety Management System

Safety Management System



Large Order? Call for Quote!



'Pull-Tite' Seals can be ordered separately



- Unique tamper-evident safety tag system – No more lost tags!
- Mark your equipment with safety information and maintenance records – ideal for plant equipment, valve identification, ladders, scaffolding and much more
- Helps you comply with health and safety legislation – essential for companies working with ISO 9000
- To use, slide in the Tags of your choice (1 each side) into the Multi-Purpose Tag Holder. Insert Safety Message Tags on slide cover side and secure slide cover with a Seal to ensure only the top or bottom of the tag is displayed
- To secure the completed Tag Holder to your equipment, use Ties (sold separately below) or attach permanently with screws
- Any broken ties or seals will identify misuse
- Add details about the condition of the equipment with Self-Adhesive Labels
- Multi-Purpose Tag Holder with Slide measures 230 x 80 mm, made from high-visibility yellow polypropylene
- Tags measure 150 x 50 mm, made from durable polyester – ideal for industrial environments
- Overlaminated, write-on, Self-Adhesive Labels measure 50 x 45 mm
- Use Permanent Markers to write on Tags and Labels

Order Ref.	Description	Packaging
702213-BR	Blank Multi-Purpose Tag Holder with Slide	10/pk
702225-BR	'Pull-Tite' Seals – Red	1000/pk
702226-BR	'Pull-Tite' Seals – Green	1000/pk
335091-BR	Permanent Marker Pens	1 piece



Custom printed Tags available on request.
Add bar coding, your company logo, or other specific requirements

Safety Message Tags & Maintenance Record Tags



229989-BR

Safety Message



229990-BR



229991-BR



229992-BR



229993-BR



229994-BR



229995-BR



229996-BR

Maintenance Record

Order Ref.	Description	Packaging
229989-BR	Safe To Use/Do Not Use	10
229990-BR	Safe To Operate/Do Not Operate	10
229991-BR	Valve Open/Valve Closed	10
229992-BR	Equipment Inspection Record	10
229993-BR	Valve Inspection Record	10
229994-BR	Ladder Inspection Record	10
229995-BR	Fork Lift Truck Inspection Record	10
229996-BR	Scaffold/Tower Inspection Record	10

Self-Adhesive Labels



229997-BR



229998-BR



229999-BR

Order Ref.	Description	Packaging
229997-BR	Do Not Use Equipment – Fault	20
229998-BR	Do Not Switch Power On	20
229999-BR	CAUTION Machinery Locked Out	20

Highly durable tags in polyester, size 150 x 50 mm.
Use a permanent marker pen for writing on you details

Write-on labels in self-adhesive laminated polyester,
size 50 x 45 mm.
Use with a permanent marker pen.

Tagout: Lockout Signs and Magnetic Identification

Coloured Nylon Ties

Allow colour coded application

Size: 200 mm x 4 mm

Material: nylon

Packaging: 100 pieces



Order Ref.	Colour
229955-BR	White
229956-BR	Blue
229957-BR	Red
229958-BR	Orange

Order Ref.	Colour
229959-BR	Yellow
229960-BR	Green
229961-BR	Violet
229962-BR	Black

Lockout Signs

Identify Equipment That Requires Lockout

Premium high quality fiberglass material.

- Rigid, durable construction
- Won't peel or fade
- Suitable for all environments, including outdoors



464A-ML



464B-ML



467A-ML

Order Ref.	Description	Dimensions
464A-ML	CAUTION. LOCK OUT FOR SAFETY	25.4 x 17.78 cm
464B-ML	CAUTION. THIS MACHINE MUST BE LOCKED OUT PRIOR TO SERVICING	25.4 x 17.78 cm
467A-ML	NOTICE. IN ACCORDANCE WITH OSHA STANDARD	35.56 x 50.80 cm

- Flexible signs fix to most surfaces
- Can be left in place permanently or removed as desired.

Order Ref.	Description	Dimensions
463A-ML	Magnetic. CAUTION. THIS MACHINE MUST	8.89 x 12.70 cm
463B-ML	Magnetic. DANGER - EQUIPMENT BEING	8.89 x 12.70 cm
469-ML	Vinyl, adhesive. CAUTION - LOCKOUT FOR SAFETY	8.89 x 12.70 cm



463A-ML



463B-ML



469-ML

Magnetic Signs

Easy to apply and remove

Size: 105 x 148 mm

Packaging: 5 pieces



Order Ref.

256964-BR



256965-BR



256966-BR



256967-BR



Contact LOTO Customer Service for information about custom magnetic signs



Large Pouches with Magnetic Strips

Ideal for attaching lockout procedures to metal racks, cabinets and other metal surfaces.

Material: vinyl

Packaging: 10 pouches

Order Ref.	Size h x w (mm)	Colour
224058-BR	305 x 225	blue
224059-BR	157 x 220	blue
224060-BR	110 x 220	blue



Pouches with Magnetic Loops

These pouches have two magnetically closing loops at the top, making them ideal to attach to trolleys and pipes.

Packaging: 10 pouches

Order Ref.	Size h x w (mm)	Colour
224061-BR	295 x 230	blue
224062-BR	155 x 220	blue

Lockout Tagout Tags



Pack of 10
'Danger - Do not Operate' Double Sided
Safety Write-On Tags with 8mm hole
Manufactured from flexible polyester.
Resistant to water.
Resistant to Oil & Extreme temperatures.
Matt surface allows you to write on them easily with a ball point or felt tip pen.
Packaging:- 10 tags with 10 cable ties
Tag Size: 76mm x 150mm
Semi Rigid

 Visit our website for a wider selection of Scafftag inserts!

Order Ref.
LOCTAG047-LT

Scafftags®: Microtag

Microtag is a safety system which is particularly useful for identifying small plant equipment & lifting gear. It also forms a clear and highly visible harness safety system which is attached by cable ties in two places. To display latest status, simply attach a tag to the harness and lanyard using the nylon ties. Before inspection, holder displays a "DO NOT USE EQUIPMENT" warning. Microtag® Kit contains 20 Holders, 40 Cable Ties and 1 Pen. Inserts available in 3 colours for your colour-coding needs. Inserts are not included in this kit but are sold separately and featured to the right.



Order Ref.
806723-BR



806727-BR 806731-BR 806735-BR



Scafftags®: Laddertag

Scafftag Laddertag Kit (10 Holders, 10 Inserts & 1 Pen)
Monitor inspections and legal compliance with unique tagging system on ladder status
Display information about ladder class and inspection periods and due dates on robust, highly visible tag
Serves as a quick reference and checklist on ladder inspection
Replacement inserts available and are featured to the right.

Order Ref.
806711-BR



806715-BR

Scafftags®

This Scafftag Kit for system scaffolds efficiently manages your inspection procedures. The unique holder and insert system provides instant feedback of scaffolding status. Caution: Fit Scafftag® at all legal access points (normally ladder access) from initial set-up to dismantling. Three insert designs available: Standard Inspection, Prohibition, and colour-coded (to indicate different loadings). Holder displays a "DO NOT USE SCAFFOLD" warning during erection, inspection waiting, failure and dismantle stages. Scafftag® Kit contains 10 Holders, 20 Standard Inspection Inserts and 2 Pens. Replacement inserts sold separately.

Order Ref.
806751-BR



806759-BR

Lockout Custom Tags

Lockout custom tags may be created to any size, legend and colour.
Minimum order: 1000 pieces
Best value for money when purchasing large quantities
Call 01642 244017 for more information.



Index



Product Description

Accessories

71CS-ML	Zinc plated steel chain with chain holder	38
71CH-ML	Zinc plated steel chain with chain holder	38
265378-BR	Brass tags & Attachment rings	38
265379-BR	Collars and Rivets	38
71SC8-ML	Shackle Collar	38
71SC9-ML	Shackle Collar	38
71TAG-ML	Brass tag with ring, attaches to shackle collars.	38
S100-ML	Lockout Leash	38
S125-ML	Padlock Caddy	38
805844-BR	"Cobra" Cable	39
805845-BR	Maximum Chain Security	39
805846-BR	Maximum Chain Security	39
0411-ML - 5705-ML	Photo I.D Labels	39
6835-ML - 5700-ML	Photo I.D Labels.	39
461-ML	Padlock labels with clear over laminate (40 Pack)	39

Ball Valves

065666-BR	Nylon Ball Valve Lockout	7
065692-BR	Brady Ball Valve Lockout (Steel)	7
065669-BR	Brady Ball Valve Lockout (Steel)	7
065693-BR	Brady Ball Valve Lockout (Steel)	7
225340-BR	Non-Conductive Ball Valve Lockout	7
800110-BR	Small Prinzing Ball Valve Lockout - Red	7
800111-BR	Large Prinzing Ball Valve Lockout - Red	7
805847-BR	Small Prinzing Ball Valve Lockout - Blue	7
805850-BR	Large Prinzing Ball Valve Lockout - Blue	7
805848-BR	Small Prinzing Ball Valve Lockout - Green	7
805851-BR	Large Prinzing Ball Valve Lockout - Green	7
805849-BR	Small Prinzing Ball Valve Lockout - Yellow	7
805852-BR	Large Prinzing Ball Valve Lockout - Yellow	7
S3068MLP	Handle On Ball Valve Lockout	8
468L-ML	Seal-Tight Ball Valve Lockout	8

Butterfly Valves

256960-BR	Butterfly Valve Lockout in Red	12
256961-BR	Butterfly Valve Lockout in Yellow	12
256962-BR	Butterfly Valve Lockout in Green	12
256963-BR	Butterfly Valve Lockout in Blue	12

Cable Lockouts

S806-ML	Adjustable Cable Lockout	11
8611-ML	Adjustable Cable Lockout	11
8615-ML	Adjustable Cable Lockout	11
225203-BR	Pro-Lock + Cable Lockout Device in Red	11
225204-BR	Pro-Lock + Cable Lockout Device in Yellow	11
225205-BR	Pro-Lock + Cable Lockout Device in Green	11
225206-BR	Pro-Lock Operating Tool in Red	11
225207-BR	Pro-Lock Operating Tool in Green	11
225208-BR	Pro-Lock Operating Tool in Yellow	11
050924-BR	Universal Valve Lockout	11
050899-BR	Universal Valve Lockout	11
051395-BR	Universal Valve Lockout	11

Cable Seals

2.5MinCabSeal-MF	2.5 mm Mini Cable Lock Seal	56
3.0MinCabSeal-MF	3.0 mm Midi Cable Lock Seal	56
3.5MinCabSeal-MF	3.5 mm Midi Cable Lock Seal	56
5.0MinCabSeal-MF	5.0 mm Maxi Cable Lock Seal	56
CABLEBREAKAWAY1.5	1.5 mm Breakaway Seal	56
CABLEBREAKAWAY2.5	2.5 mm Breakaway Seal	56
CABLEBREAKAWAY5.0	5.0 mm Breakaway Seal	56
2.5MinCabSeal-MF	2.5 mm Mini Cable Lock Seal	57
3.0MinCabSeal-MF	3.0 mm Midi Cable Lock Seal	57
3.5MinCabSeal-MF	3.5 mm Midi Cable Lock Seal	57
5.0MinCabSeal-MF	5.0 mm Maxi Cable Lock Seal	57
CABLEBREAKAWAY1.5	1.5 mm Breakaway Seal	57

Circuit Breaker Lockouts

066321-BR	Universal Multi-Pole Breaker Lockout	17
066320-BR	Universal Multi-Pole Breaker Lockout (Pack of 6)	17
805814-BR	Economy Multi-Pole Breaker Lockout	17
065387-BR	Single Pole Circuit Breaker Lockout	17
065688-BR	Single Pole Circuit Breaker Lockout (Pack of 6)	17
065396-BR	"No Hole" Circuit Breaker Lockout	17
065965-BR	"No Hole" Circuit Breaker Lockout	17
065397-BR	"No Hole" Circuit Breaker Lockout	17
065966-BR	"No Hole" Circuit Breaker Lockout	17
S2390-ML	Circuit Breaker Lockout	18
S2391-ML	Circuit Breaker Lockout	18
S2392-ML	Circuit Breaker Lockout	18
S2393-ML	Circuit Breaker Lockout	18
S2300AST-ML	Circuit Breaker Lockout	18
KITELEC-SF09-ML	Circuit Breaker Lockout	18
MCB-NOTOOL	NO TOOL Mini Circuit Breaker	18
065329-BR	Oversized Breaker Lockout Device	19
065321-BR	Oversized Breaker Lockout Device (Pack of 6)	19
090891-BR	Breaker Blocker Kit	19
090892-BR	Breaker Blocker Components	19
090893-BR	Breaker Blocker Components	19
051264-BR	Breaker Blocker Components	19
051265-BR	Breaker Blocker Components	19
090844-BR	Miniature Circuit Breaker Lockouts	20
090845-BR	Miniature Circuit Breaker Lockouts (Pack of 6)	20
090847-BR	Miniature Circuit Breaker Lockouts	20
090848-BR	Miniature Circuit Breaker Lockouts (Pack of 6)	20
090850-BR	Miniature Circuit Breaker Lockouts	20
090851-BR	Miniature Circuit Breaker Lockouts (Pack of 6)	20

Product Description

090853-BR	Miniature Circuit Breaker Lockouts	20
090854-BR	Miniature Circuit Breaker Lockouts (Pack of 6)	20
805853-BR	Miniature Circuit Breaker Lockouts Demo Kit	20
491B-ML	Circuit breaker lockout, tall and wide toggles	21
493B-ML	Circuit breaker lockout, single and double toggles	21
506-ML	Set of each device - one 491B and one 493B	21
7C5RED-ML	Circuit Breaker Switch Padlock	21
469B-ML	Universal Wall Switch Lockout	21
UFL2	Circuit Breaker Lockout	21

Cylinder & Pneumatic Lockout

046139-BR	Cylinder Tank Lockout	13
045629-BR	Gas Cylinder Lockout	13
064221-BR	Pneumatic Quick-Disconnect Lockout	13
065645-BR	Pneumatic Quick-Disconnect Lockout (Pack of 6)	13
S3900-ML	Stainless Steel Pneumatic Lockout	14
800126-BR	Large Electrical/Pneumatic Lockout	15

Economy & Lock Options

3100-3108-ST	Economy Range Key Cabinet	50
Model GL	Steel Wall Mounted or Portable Group Box	50

Gate Valves

064057-BR	Adjustable Gate Valve Lockout	9
0655GV-BR	Standard Gate Valve Lockout in Red	9
480 - 485-ML	Rotating Gate Valve Lockout	10
S3910-ML	Pressurized Gas Cylinder Lockout	10

I.D Tags, Holders & Stations

497A-ML	Do Not Operate: I.D Tags	60
800125-BR	Tag Holder	60
081773-BR	Safety Tag Station	60
S1601-ML	Compact Tag Stations Unfilled	60
S1601A-ML	Compact Tag Stations	60
S1601AX-ML	Compact Tag Stations	60
S1601FRC-ML	Compact Tag Stations	60
S1800-ML	Deluxe Tag Lockout Centre Unfilled	60

Key Filing System

System 60/HS-SK	High Security Systems - 60 keys	51
System 100/HS-SK	High Security Systems - 100 keys	51
System 150/HS-SK	High Security Systems - 150 keys	51
System 200/HS-SK	High Security Systems - 200 keys	51
System 300/HS-SK	High Security Systems - 300 keys	51
System 50/HS Deep	High Security Seep Systems - 50 bunches	51
System 100/HS Deep	High Security Seep Systems - 100 bunches	51
System FR 960-SK	Floor Standing Systems - 960 keys	51
System FR 1280-SK	Floor Standing Systems - 1280 keys	51
System FR 1560-SK	Floor Standing Systems - 1560 keys	51
System FR 2080-SK	Floor Standing Systems - 2080 keys	51

Key Reels

Super 48-SK	Key Bak	55
Super 48 Belt Loop-SK	Key Bak	55
Heavy Duty-SK	Key Bak	55
Original-SK	Key Bak	55
Bracket Mounted-SK	Key Bak	55
Karabiner-Chain-SK	Securit	55
Karabiner-Cord-SK	Securit	55
Standard Split Ring-SK	Midi Bak - 900mm	55
Standard Split Ring-SK	Mini Bak - 600mm	55
I.D Card Holder-SK	Mini Bak	55
Key Release-SK	Accessories	55
Hus Key-SK	Accessories	55
Pocket Key Chain-SK	Accessories	55
Karabiner With Split-SK	Accessories	55

Key Vault

Key Vault-SK	Key Vault	52
Key Vault Deep-SK	Deep Key Vault	52

Lock Boards

050989-BR	5-Lock Board (Board Only)	46
050990-BR	10-Lock Board (Board Only)	46
050992-BR	36-Lock Board (Board Only)	46
050991-BR	20-Lock Board (Board Only)	46

Lockout Boxes & Padlock Stations

002710-KW	Type 1 Lockout Box	43
002721-KW	Type 2 Lockout Box	43
503-ML	Dual Application Group Lock Box	48
498A-ML	Portable Group Lock Box	48
8001-BR	Lockout Centre 18 hooks	48

Lockout Hasps

416-ML	Spark Resistant Aluminum	40
417-ML	Spark Resistant Aluminum	40
418-ML	Heavy Duty Steel	40
419-ML	Heavy Duty Steel	40
420-ML	Steel Jaw with Vinyl Coated Handle	40
421-ML	Steel Jaw with Vinyl Coated Handle	40
427-ML	Labelled Snap-On red hasp	40
428-ML	Nylon Non-Conductive Hasp	40
429-ML	Dual Jaw Aluminum Hasp	40
ALO80-ML	Tabbed Steel Jaw with Vinyl Coated Handle	40
ALO80M2-ML	Tabbed Steel Jaw with Vinyl Coated Handle	40
S430-ML	Safety Lockout Hasps	40

T: 01642 244017

Web Ordering : www.LockoutTagout.co.uk





Index

Product Description		
S431-ML	Safety Lockout Hasps	40
701-HO	Steel Jaw with Vinyl Coated Handle	40
702-HO	Steel Jaw with Vinyl Coated Handle	40
045582-BR	Non-conductive Lockout Hasp	41
236916-BR	Nylon Lockout Hasp	41
805840-BR	Safety Lockout in Red	41
805841-BR	Safety Lockout in Red	41
805842-BR	Safety Lockout in Yellow	41
805843-BR	Safety Lockout in Yellow	41
236920-BR	Economy Lockout	42
236919-BR	Stubby Lockout	42
236918-BR	Lockout Device	42
230000-BR	Lockout Device + chain (150mm)	42
265399-BR	Blank Safety Lockout Hasps in Red	42
225199-BR	Blank Safety Lockout Hasps in Blue	42
225198-BR	Blank Safety Lockout Hasps in Green	42
225197-BR	Blank Safety Lockout Hasps in Gold	42
225196-BR	Blank Safety Lockout Hasps in Silver	42
265390-BR	Do not operate	42
265393-BR	Labelled Safety Lockout Hasps	42
265391-BR	Labelled Safety Lockout Hasps	42
265392-BR	Labelled Safety Lockout Hasps	42

Lockout Kits, Pouches and Bags		
806178-BR	Ultimate Lockout Kit	22
1456-ML	Personal Lockout Pouches	23
S315-ML	Series Compliance Centers	23
S316-ML	Series Compliance Centers	23
S317-ML	Series Compliance Centers	23
S330-ML	Series Compliance Centers	23
S331-ML	Series Compliance Centers	23
1457-ML	Personal Lockout Kit	24
1458-ML	Personal Lockout Kit	25
806176-BR	Small Adjustable Lockout Kit	26
806190-BR	Gate Valve Lockout Kit	26
805877-BR	Lockout Starter Kit	26
050979-BR	Large Lockout Pouch	49
051172-BR	Lockout Belt Pouch	49
806200-BR	Lockout Satchel	49
099162-BR	Lockout Duffel Bag	49

Lockout Signs & Magnetic Identification		
464A-ML	Lockout Signs	62
464B-ML	Lockout Signs	62
467A-ML	Lockout Signs	62
463A-ML	Lockout Signs	62
463B-ML	Lockout Signs	62
469-ML	Lockout Signs	62
256964-BR	Magnetic Signs	62
256965-BR	Magnetic Signs	62
256966-BR	Magnetic Signs	62
256967-BR	Magnetic Signs	62
224058-BR	Large Pouches with Magnetic Strips	62
224059-BR	Large Pouches with Magnetic Strips	62
224060-BR	Large Pouches with Magnetic Strips	62
224061-BR	Pouches with Magnetic Loops	62
224062-BR	Pouches with Magnetic Loops	62

Lockout & Tag Stations		
1482B-ML	Padlocks Stations	43
1483B-ML	Padlocks Stations	43
1484B-ML	Padlocks Stations	43
1482BP410-ML	Padlocks Stations	43
1483BP410-ML	Padlocks Stations	43
1484BP410-ML	Padlocks Stations	43
S1900VE410-ML	Deluxe Lockout Stations	44
S1900-ML	Deluxe Lockout Stations	44
S1850-ML	Deluxe Lockout Stations	44
S1850P410-ML	Deluxe Lockout Stations	44
S1850VA410-ML	Deluxe Lockout Stations	44
S1705P410-ML	Tag Stations	45
S1720E410-ML	Tag Stations	45
S1745E410-ML	Tag Stations	45
S1700-ML	Tag Stations	45
800123-BR	Industrial Strength Lockout Station	48
800129-BR	Industrial Strength Lockout Station - Extra Shelf	48

LOTO Training Tools		
805855-BR	Lockout-Tagout Training DVD	3
J1615-ML	Lockout Safety Installation Videos	3
499PR-ML	Lockout Training Programme Reference Cards	3

Padlocks		
406-ML	Non-Conductive Safety Padlock	30
410-ML	Zenex Safety Padlock	29
411-ML	Zenex Safety Padlock	29
S31-ML	Zenex Safety Padlock	28
S32-ML	Zenex Safety Padlock	28
S33-ML	Zenex Safety Padlock	28
051344-BR	Brady Safety Padlocks in Blue	30
051339-BR	Brady Safety Padlocks in Red	30
051353-BR	Brady Safety Padlocks in Black	30
051346-BR	Brady Safety Padlocks in Yellow	30
051345-BR	Brady Safety Padlocks in Green	30
051347-BR	Brady Safety Padlocks in Orange	30
41/40	ABUS Safety Padlocks	30
72/40 KA BLK	Aluminium Padlocks 24.5mm Shackle	31

Product Description		
72/40HB40 KA BLK	Aluminium Padlocks 38mm Shackle	31
83AL/40 S2	ABUS 83AL/40 Series 2 Aluminium Padlock	31
T84MB/40	Full Brass Padlocks 21.5mm Shackle	31
PL362-AB	Abloy PL362 Padlock	32
PL330-AB	Abloy PL330 Padlock	32
PL321-AB	Abloy PL321 Padlock	33
82-ABUS	Shutter Padlocks	33
70AL/45	Fully Insulated Locks	33
PL340-AB	Abloy PL340 Padlock	34
37RK	High Security Granit Padlock Shackle	34
PL350-AB	Abloy PL350 Padlock	34
PL342-AB	Abloy PL342 Padlock	35
PL341-AB	Abloy PL341 Padlock	35
37/55-AB	Granit Padlock Keyed Alike Option Available	35
C125BS-V15-BG	Brass Padlock with Brass Shackle	36
C250BS-V25-BG	Brass Padlock with Brass Shackle	36
C150BS-V19-BG	Brass Padlock with Brass Shackle	36
65MB/15C	3mm Brass Padlock	37
AS2501-ALD	3mm Brass Padlock	37
145-ABUS	Aluminium Combination Padlock 3mm Shackle	37
165-ABUS	Aluminium Combination Padlock 3mm Shackle	37

Padlock Stations & Lock		
S1506-ML	Heavy Duty Padlock Station	47
S1518-ML	Heavy Duty Padlock Station	47
800120-BR	Small Padlock Station	47
800121-BR	Large Padlock Station	47
065699-BR	Group Lock Box in Red	47
045190-BR	Group Lock Box in Blue	47
065672-BR	Group Lock Box in Yellow	47

Plug Lockouts		
065674-BR	Lockout Device for Plug Connections	15
065675-BR	Lockout Device for Plug Connections	15
065695-BR	Hubbel Plugout for Industrial Plug Connections	15
065968-BR	Hubbel Plugout for Industrial Plug Connections	15
S2005-ML	Small Electrical Plug Lockout	16
S2151-ML	Removable Push Button and Rotary Switch Cover	16
S2153-ML	Permanent Push Button and Rotary Switch Cover	16
487-ML	Electrical Plug Lockout	16
488-ML	Electrical Plug Lockout	16
453-ML	Oversized Plug & Hoist Control Cover	16

Safety Management System		
702213-BR	Safety Management System	61
702225-BR	Safety Management System	61
702226-BR	Safety Management System	61
335091-BR	Safety Management System	61
229989-BR	Safety Message & Maintenance Record Tags	61
229990-BR	Safety Message & Maintenance Record Tags	61
229991-BR	Safety Message & Maintenance Record Tags	61
229992-BR	Safety Message & Maintenance Record Tags	61
229993-BR	Safety Message & Maintenance Record Tags	61
229994-BR	Safety Message & Maintenance Record Tags	61
229995-BR	Safety Message & Maintenance Record Tags	61
229996-BR	Safety Message & Maintenance Record Tags	61
229997-BR	Self-Adhesive Labels	61
229998-BR	Self-Adhesive Labels	61
229999-BR	Self-Adhesive Labels	61
2299-BR	Coloured Nylon Ties	62

Security Systems		
System PL-SK	Padlock Security Systems - 24 keys	54
System G-SK	Key View Systems	54
System H-SK	Portable Systems	54

Steering Wheel Covers		
4716-ML	Steering Wheel Covers - Small	14
4720-ML	Steering Wheel Covers - Medium	14
4724-ML	Steering Wheel Covers - Large	14

System Cabinets		
System -SK	System Cabinets	53
System D-SK	Deep Systems	53

Tags & Labels		
230778 - 230781-BR	Warning Tags: Machine Related Risks	59
230782 - 230789-BR	Self-Adhesive Labels: Machine Safety	59
Warning Tags	Tagout: Warning Tags	58
087052-BR	Tagout: Permanent Marker	58
Brady Safety Tags	Brady Safety Tags	59
LOCTAG047-LT	Lockout Tagout Tags	63
806723-BR	Scafftags: Microtag	63
8067-BR	Scafftags: Microtag Inserts	63
806711-BR	Scafftags: Laddertag	63
806715-BR	Scafftags: Laddertag Inserts	63
806751-BR	Scafftags	63
806759-BR	Scafftags Inserts	63

Universal Valve Lockout		
050924-BR	Small Universal Valve Lockout	6,12
050899-BR	Large Universal Valve Lockout	6,12
065402-BR	Universal Valve Lockout Small Blocking Arm	6
065403-BR	Universal Valve Lockout Large Blocking Arm	6
051395-BR	Universal Valve Lockout Cable Attachment	6

INDEX

T: 01642 244017

Web Ordering : www.LockoutTagout.co.uk





Lockout Tagout Safety Ltd.

4D Brighthouse Road - River Court - Middlesbrough - UK
TS2 1RT

Tel: +44 (0)1642 244017 - Fax +44 (0)1642 230497
Email: info@lockout-tagout.co.uk

www.LockoutTagout.co.uk
Protect Employees & Comply With Legislation

